



INSTALLATION GUIDE

2022+ FRONTIER BASE REAR



NOTE

SKILL LEVEL - ★★★

1 STAR ★☆☆☆☆

2 STARS ★★☆☆☆

3 STARS ★★★☆☆

4 STARS ★★★★☆

5 STARS ★★★★★

EASY - No tools required

BASIC - Requires standard tools, basic mechanical knowledge and understanding

MODERATE - Requires standard tools. Some drilling and/or cutting.

ADVANCED - Requires speciality tools. Drilling, cutting, and/or welding

EXPERT - Professional installation recommended.

DISCLAIMER

Expedition One is not responsible for any damages to vehicle or injury.

We always recommend professional assistance when installing our vehicle products.

Always follow safety precautions including the use safety gear and devices.

We highly recommend customers wait until they have the product in hand to schedule installations. All cancellations are required in writing and will incur a 10% re-stock fee and any applicable packaging and shipping fees. Please review terms and conditions for details.

- Vehicle manufactures regularly update and change parts or hardware. Instructions and photos reflect the install and vehicle at the time. Account for your vehicle as needed.
- Not guaranteed to work with other aftermarket equipment.
- Items such as light ports are made to be universal and may require modification or use of spacers to fit
- Sensor holes are included however they are not guaranteed to work.
- A narrow wheel with an extreme positive offset and a very wide tire may not work with the standard tire mount

This product contains chemicals known to the state of California to cause birth defects or other reproductive harm. For more information go to www.p65warnings.gov

HARDWARE

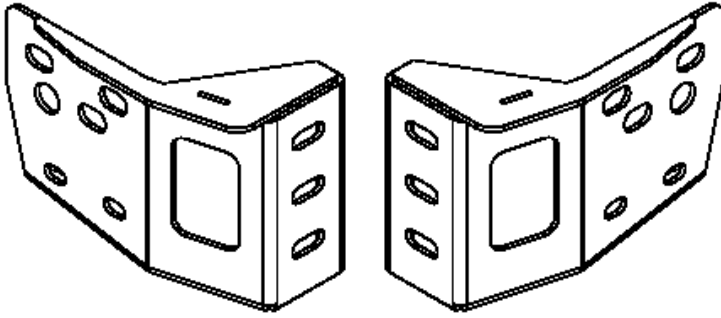

MOUNTING BRACKETS

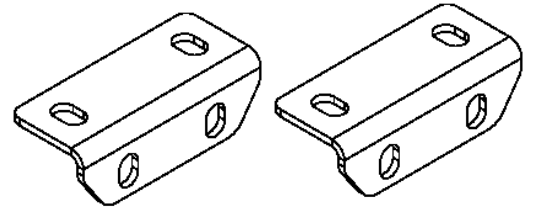

REINFORCEMENT BRACKETS

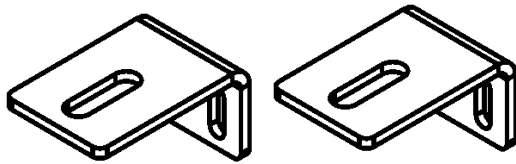

LIGHT BRACKETS

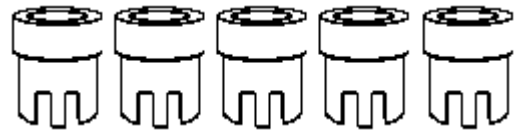

SENSOR BEZELS

BASE REAR BUMPER HARDWARE

- 1/4" – 20 X 3/4" HEX CAP HEAD 4
- 1/4" – 20 CLIP NUT 4
- 1/4" SAE WASHER 4
- 1/2" – 13 X 1 1/2" HEX CAP BOLT 10
- 1/2" – 13 NYLOC NUT 10
- 1/2" USS WASHER 20

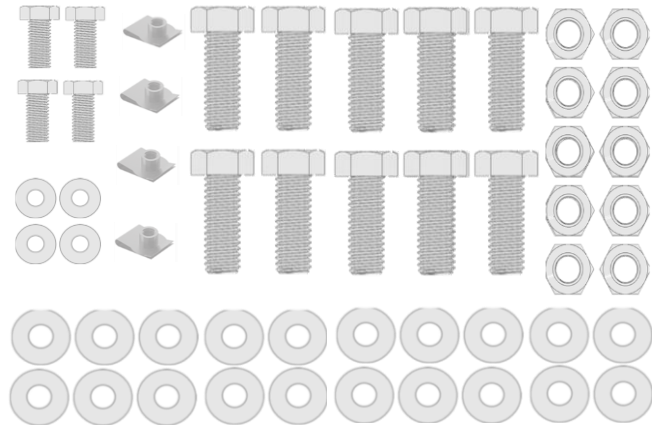

Please note that models equipped with the blind spot monitor will not function with an aftermarket bumper due to the monitors capability to sense through steel.

EXTRA HARDWARE MAY BE LEFT OVER DUE TO MODEL OR OPTION SPECIFIC HARDWARE THAT MAY NOT BE REQUIRED FOR THE INSTALL.

INSTALLATION

1 DISCONNECT WIRING HARNESS

Disconnect the rear bumper's parking sensors and license plate light wiring harness via the drivers side connector located in the corner of the bumper

2 REMOVE OEM HARDWARE AND BUMPER

Remove the rear bumper and OEM frame mount hardware. Save the OEM hardware installation of the frame brackets later

3 PARKING SENSOR INSTALLATION

Place the OEM wiring harness into the new bumper, threading the wiring through so that connectors match there respective positions. Make sure the wiring harness connector is located on the correct side of the vehicle. Reattach all 4 parking sensors to the provided sensor bezels. Avoid placing the wiring harness near mounting holes and visible cutouts. Mount any aftermarket lights at this time.

4 LIGHT TABS

Mount the provided light tabs now or after the bumper is installed (allows for more access to hardware during bumper mounting).

1/4" – 20 X 3/4" HEX CAP HEAD	4
1/4" – 20 CLIP NUT	4
1/4" USS WASHER	4

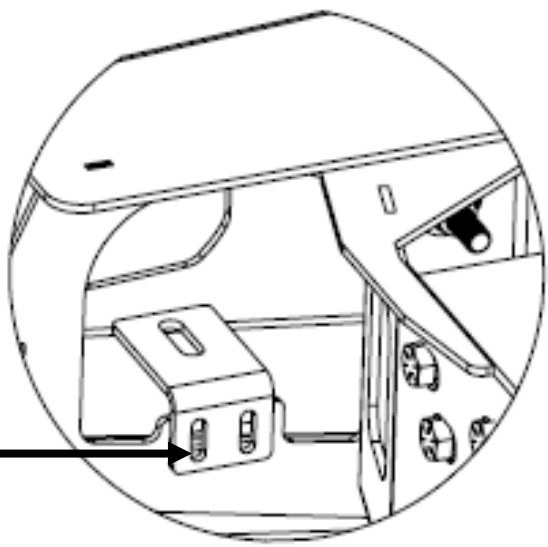

5 FRAME MOUNTING BRACKETS

Attach the frame bracket next to the frame as shown. Mount using the OEM Hardware. Leave all hardware loose for adjustment.



OEM HARDWARE 6

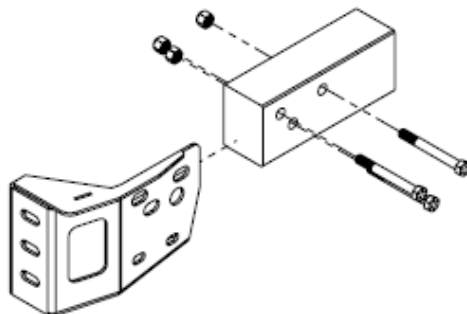
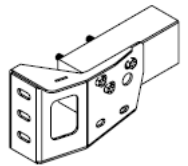
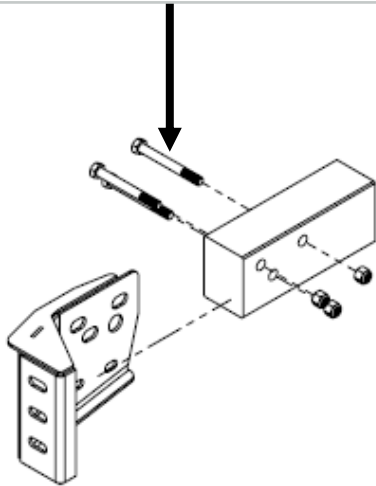

6 REINFORCEMENT BRACKETS

Attach the reinforcement brackets next to the frame and mounting brackets as shown. Mount using the provided 1/2" and OEM Hardware. Leave all hardware loose for adjustment.

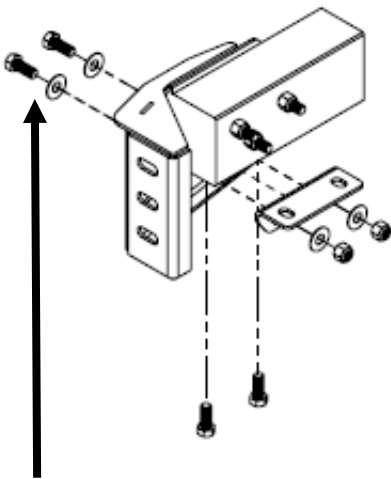

1/2" - 13 x 1 1/4" HEX CAP BOLT	4
1/2" - 13 NYLOC NUT	4
1/2" USS WASHER	8

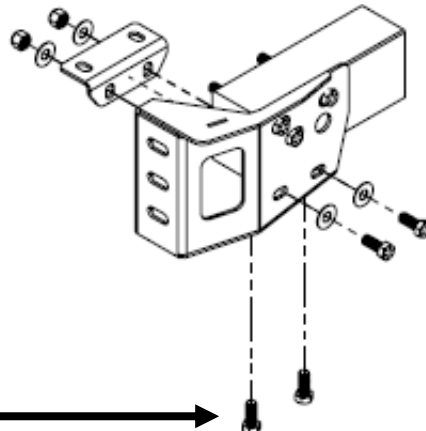
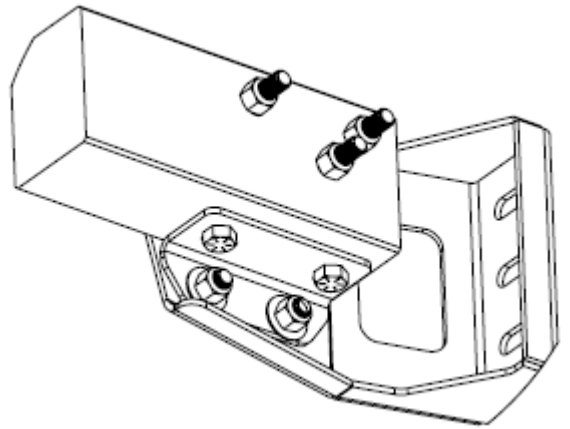

OEM HARDWARE	4
--------------	---

7 BUMPER INSTALLATION

Mount to the vehicle using the provided 1/2" hardware as shown to the mounting brackets. Leave hardware loose for adjustment and tighten once in place including frame mounts

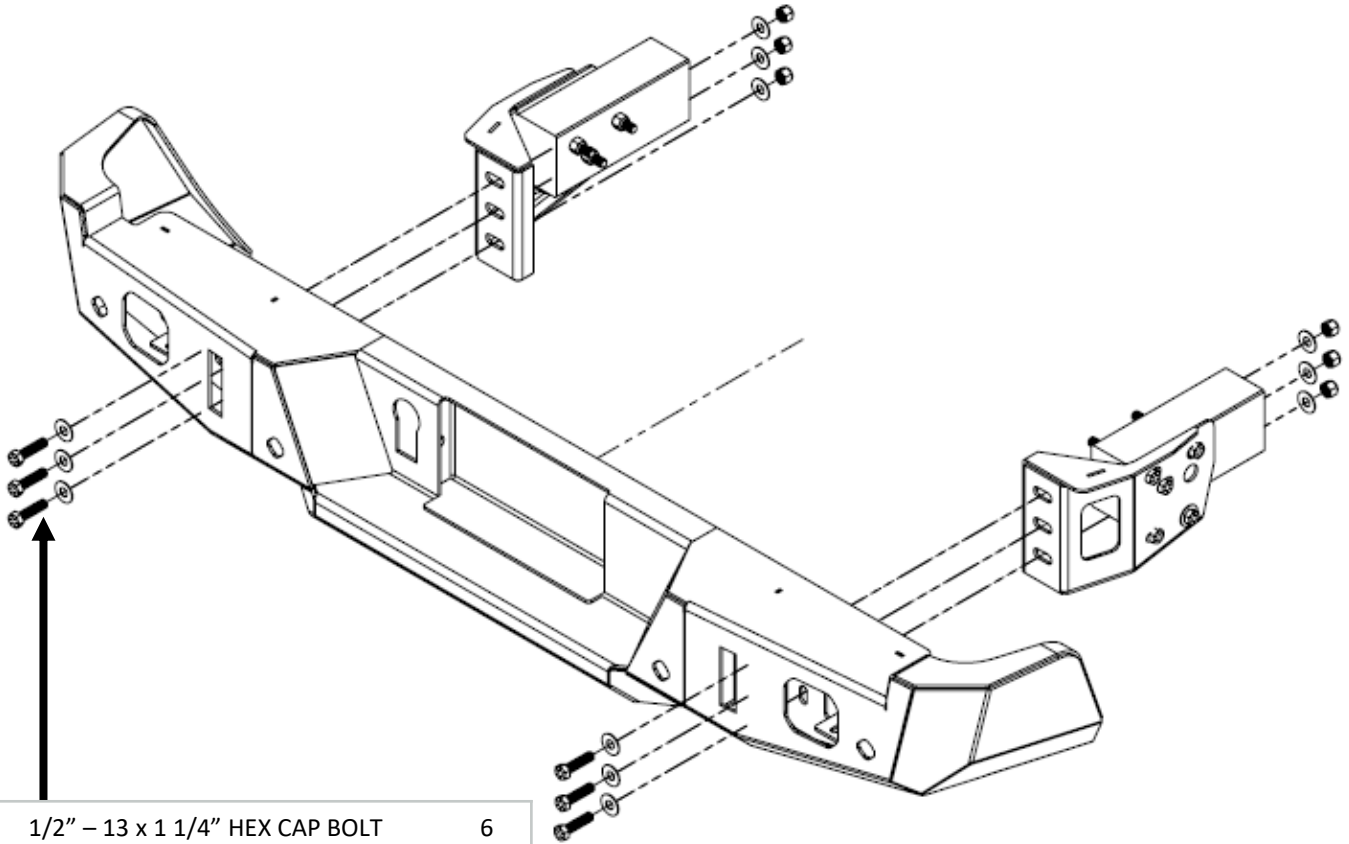

1/2" - 13 x 1 1/4" HEX CAP BOLT	6
1/2" - 13 NYLOC NUT	6
1/2" USS WASHER	12

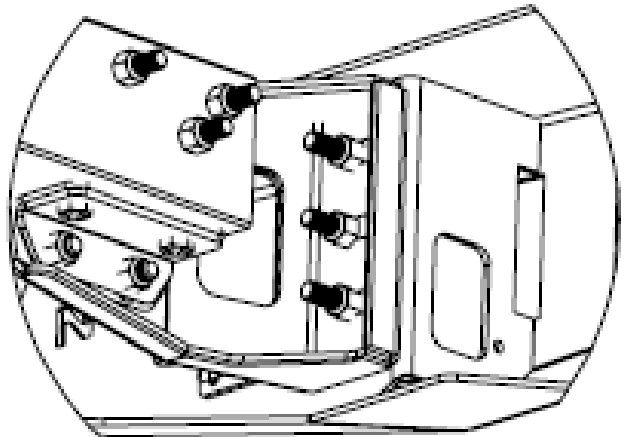
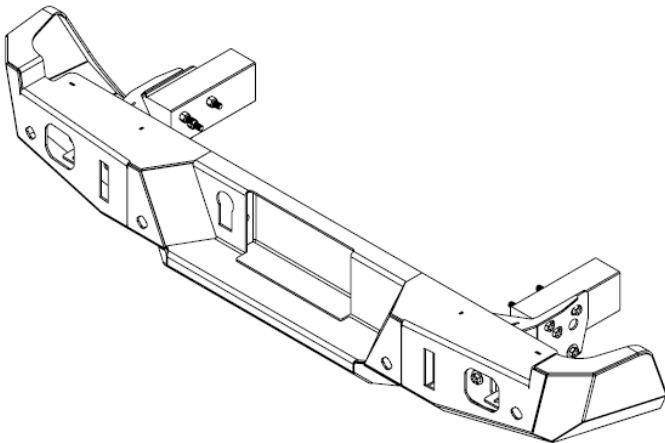

8 LICENSE PLATE LIGHT INSTALLATION

Remove the original license plate lights by cutting off a small section of wire. Attach one set of connectors to the original wiring loom, connecting the opposite set to the provided lights. Insert the provided license plate light into the bumper. Connecting the wiring loom and light wires via the connectors.



9 RECONNECT WIRING HARNESS

Reconnect the parking sensor and cornering light wiring harness to the vehicles electronics. .

10 TIGHTEN ALL HARDWARE

Check that all hardware is tightened including all brackets and mounting locations.

TIGHTEN ALL HARDWARE AFTER EVERYTHING IS INSTALLED ON THE VEHICLE.

CHECK AND RETIGHTEN ALL HARDWARE AFTER THE FIRST 100 MILES AND AFTER OFF ROADING.

CHECK REGULARLY

ADDITIONAL LINKS

<https://www.exp-one.com/wp-content/uploads/2016/10/Proper-Care-and-Maintenance.pdf>

<https://www.exp-one.com/wp-content/uploads/2016/10/Paint-touch-up-instructions.pdf>