

INSTALLATION GUIDE

LEXUS GX SAM MULE ROOF RACK



CONTENTS

HARDWARE

ITEM	QTY	ITEM	QTY
LEXUS GX SAM MULE ROOF RACK		BASE RACK	
Side Fascia	2	Load Bars* - GX 46"	4
Front Roof Mount	2	Load Bar End Caps	10
Middle Roof Mount	2	5/16"-18 X 3/4" Button Head Bolts	28
Rear Roof Mount	2	5/16"-18 Nyloc Nuts	12
Medium Spacer	6		
Larger Spacer	18	BASE RACK + ADDITIONAL LOAD BARS	
Foam Strip - 24"	1	Load Bars* - GX 46"	7
		Load Bar End Caps	4
ROOF MOUNT HARDWARE		5/16"-18 X 3/4" Button Head Bolts	28
M8 - 1.25 X 50mm Hex Cap Bolt	12		
5/16 USS Washers	12	OPTIONAL FRONT AIR DAM	
		5/16"-18 X 1" Carriage Bolt	2
		5/16" -18 Nyloc Nut	2
		5/16" USS Washer	2
		Weather Stripping - 63"	1

SKILL LEVEL - 3 STARS



1 STAR	★☆☆☆☆
2 STARS	★★☆☆☆
3 STARS	★★★☆☆
4 STARS	★★★★☆
5 STARS	★★★★★

EASY - No tools required
BASIC - Requires standard tools, basic mechanical knowledge and understanding
MODERATE - Requires standard tools. Some drilling and/or cutting.
ADVANCED - Requires speciality tools. Drilling, cutting, and/or welding
EXPERT - Professional installation recommended.

DISCLAIMER

Expedition One is not responsible for any damages to vehicle or injury.
We always recommend professional assistance when installing our vehicle products.

Always follow safety precautions including the use safety gear and devices.

NOTE

Due to the nature of aluminum, rack pieces including fascia parts may require time to "relax" or return to shape before mounting. Do not force parts into place. Leave all hardware loose before tightening to allow for adjustment.

Exact load bar dimensions may vary due to the manufacturing process

ROOF RACK PREPERATION

ATTENTION

When assembling the Mule Ultra Rack, remember to hand-tighten all bolts relatively loose until the very end of the install. This allows everything to fit into place before everything is tightened down.

1 OEM ROOF RACK REMOVAL

Remove the OEM roof rack from the vehicle by undoing the hardware located at each mount.

2 ROOF MOUNTS

In preparation for attaching the roof mounts cut a foam strip to lenght of the mounting location and place 3 of the large (thicker) spacers over the mounting location. Repeat this step for the other five mounts.

The Medium (thin) spacers are optional and my be used to level or adjust the rack height if desired.



OPTIONAL FRONT AIR DAM

Attach the provided weather stripping to the underside of the air dam and trim to fit. Mount the air dam to the front load bar as shown during assembly of the roof rack using the 5/16" hardware.

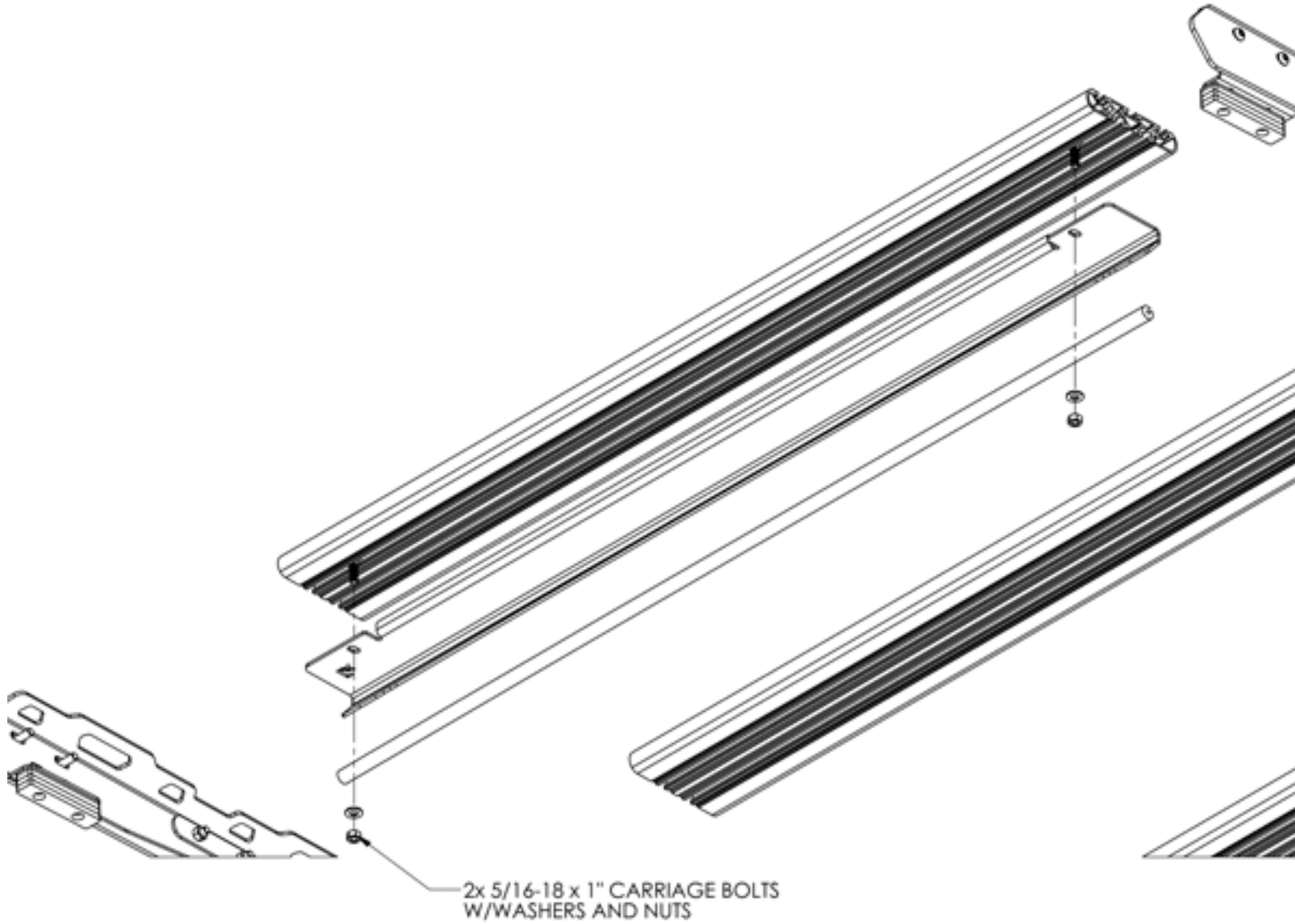

RACK ASSEMBLY

BASE RACK ASSEMBLY

Assemble the rack as shown below. Start by attaching one side fascia to the associated mounts and end caps with the load bars. Mounts are labeled for each location (F - Front, M - Middle, and R - Rear). Leave the hardware loose for adjustment. Repeat this step for the other side, again do not tighten the hardware. If purchased, mount the front face plate at this time. Once assembled place the rack on the vehicle and align with the roof mount locations. Level and adjust the rack with the provided medium(thin) spacers as needed. Mount using the provided M8 hardware and tighten all hardware once completed.

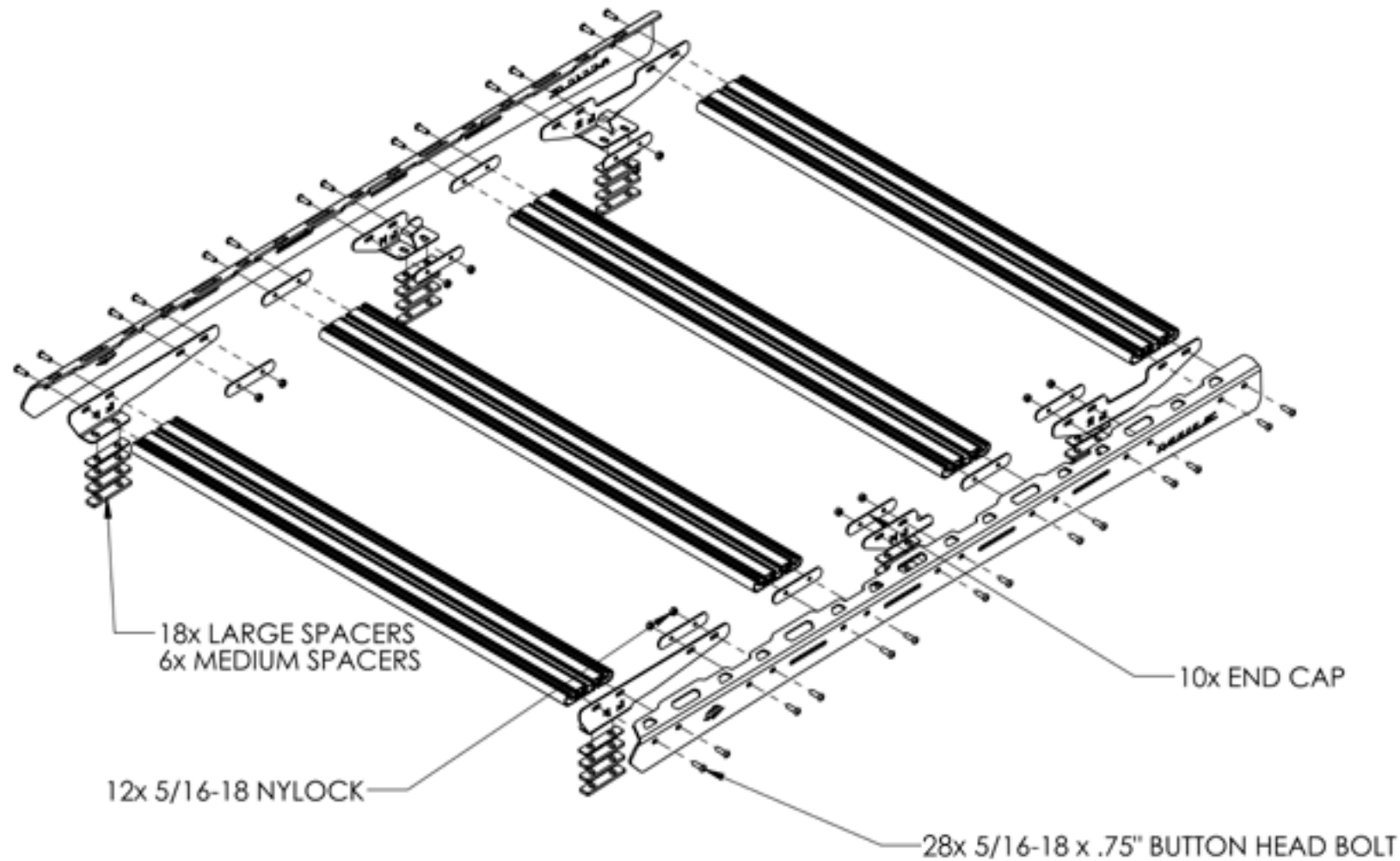

BASE RACK ASSEMBLY + ADDITIONAL LOAD BARS

Assemble the rack as shown below. Start by attaching one side fascia to the associated mounts and end caps with the load bars. Mounts are labeled for each location (F - Front, M - Middle, and R - Rear). Leave the hardware loose for adjustment. Repeat this step for the other side, again do not tighten the hardware. If purchased, mount the front face plate at this time. Once assembled place the rack on the vehicle and align with the roof mount locations. Level and adjust the rack with the provided medium(thin) spacers as needed. Mount using the provided M8 hardware and tighten all hardware once completed.

