

# INSTALLATION GUIDE

**Nissan Xterra Mule Roof Rack**



# CONTENTS

---

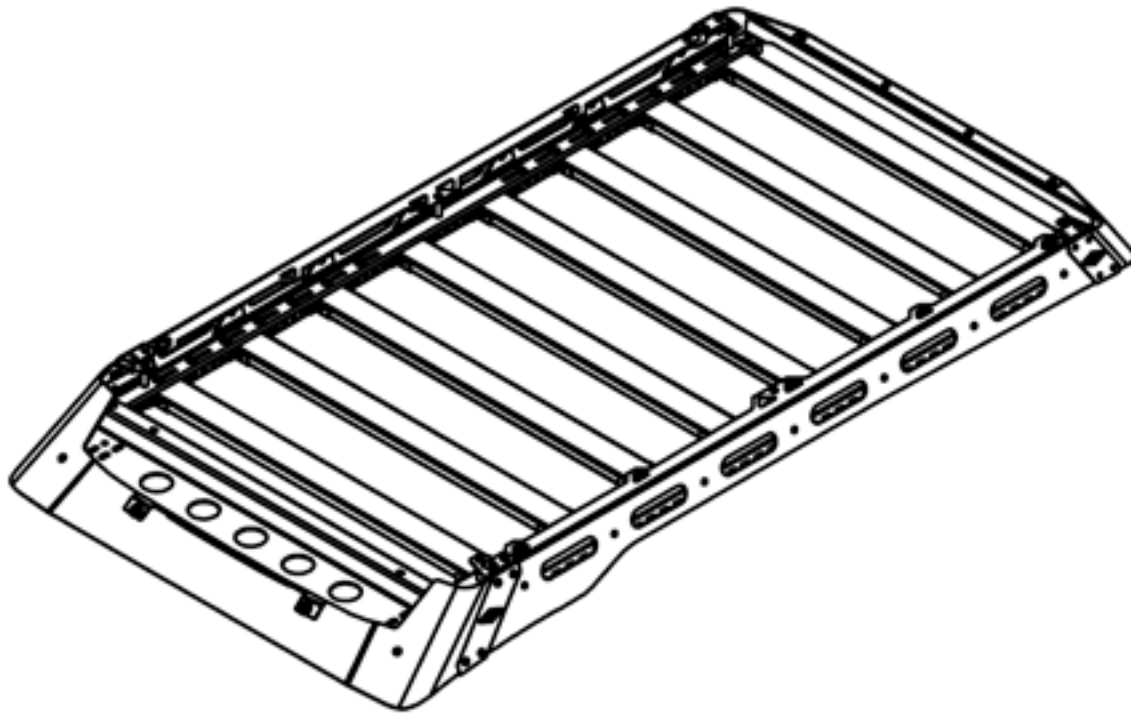

SKILL LEVEL - 3 STARS



- 1 STAR ★☆☆☆☆
- 2 STARS ★★☆☆☆
- 3 STARS ★★★☆☆
- 4 STARS ★★★★☆
- 5 STARS ★★★★★

- EASY - No tools required
- BASIC - Requires standard tools, basic mechanical knowledge and understanding
- MODERATE - Requires standard tools. Some drilling and/or cutting.
- ADVANCED - Requires speciality tools. Drilling, cutting, and/or welding
- EXPERT - Professional installation recommended.

## DISCLAIMER

Expedition One is not responsible for any damages to vehicle or injury.  
We always recommend professional assistance when installing our vehicle products.

Always follow safety precautions including the use safety gear and devices.

## NOTE

Due to the nature of aluminum, rack pieces including fascia parts may require time to “relax” or return to shape before mounting.  
Do not force parts into place. Leave all hardware loose before tightening to allow for adjustment.

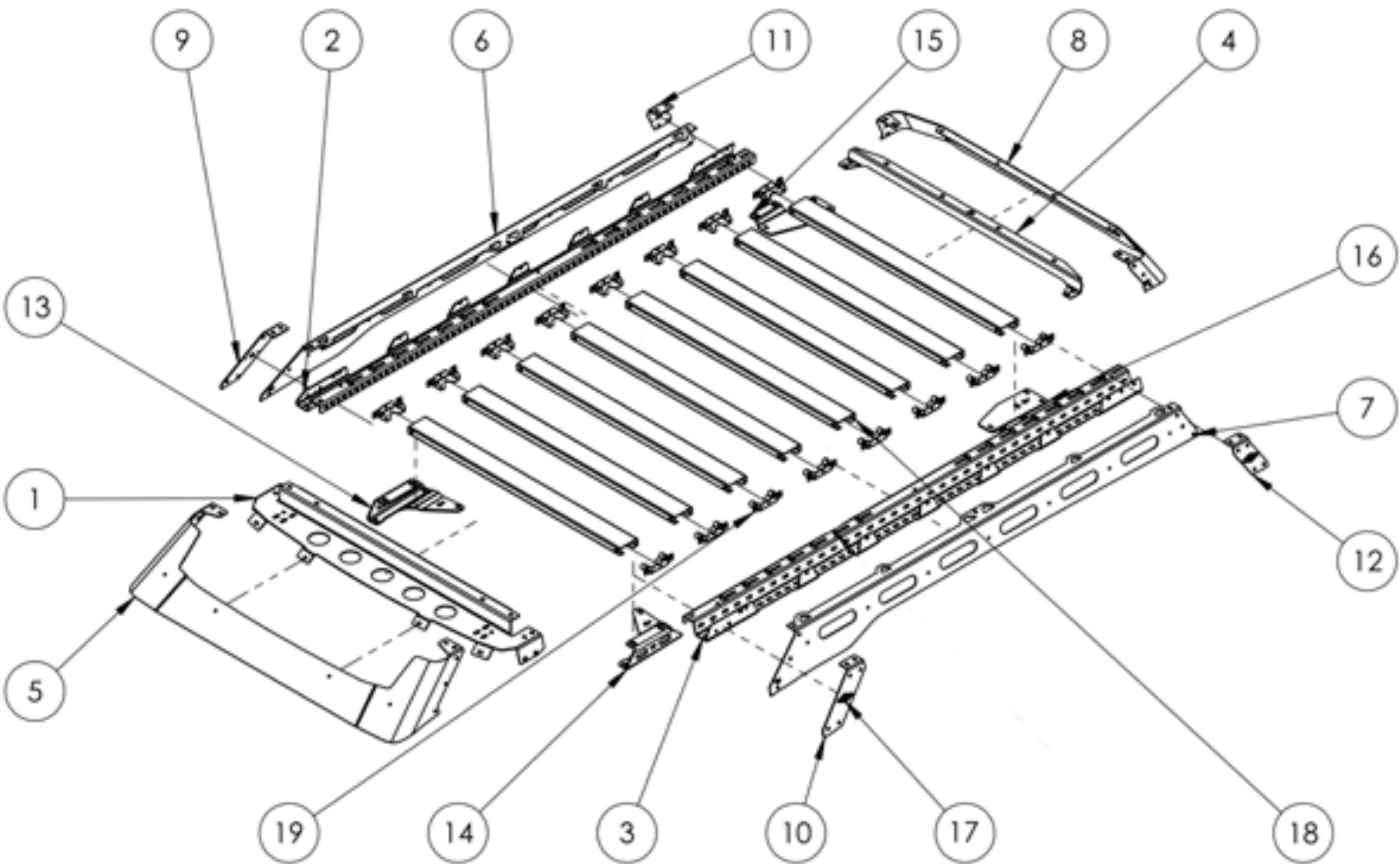

ITEM NO.	Default/QTY.	PART NUMBER	DESCRIPTION
1	1	ML-XTRRA-ULTRA-RK101	FRONT BRACE
2	1	ML-XTRRA-ULTRA-RK102	RIGHT RAIL
3	1	ML-XTRRA-ULTRA-RK103	LEFT RAIL
4	1	ML-XTRRA-ULTRA-RK104	REAR BRACE
5	1	ML-XTRRA-ULTRA-RK105	FRONT
6	1	ML-XTRRA-ULTRA-RK106	RIGHT SIDE
7	1	ML-XTRRA-ULTRA-RK107	LEFT SIDE
8	1	ML-XTRRA-ULTRA-RK108	REAR
9	1	ML-XTRRA-ULTRA-RK109	FRONT RIGHT SIDE SEAM JOINER
10	1	ML-XTRRA-ULTRA-RK110	FRONT LEFT SEAM JOINER

ITEM NO.	Default/QTY.	PART NUMBER	DESCRIPTION
11	1	ML-XTRRA-ULTRA-RK111	REAR RIGHT SEAM JOINER
12	1	ML-XTRRA-ULTRA-RK112	REAR LEFT SEAM JOINER
13	1	ML-XTRRA-ULTRA-RK113	FRONT RIGHT ROOF MOUNT
14	1	ML-XTRRA-ULTRA-RK114	FRONT LEFT ROOF MOUNT
15	1	ML-XTRRA-ULTRA-RK117	REAR RIGHT ROOF RACK
16	1	ML-XTRRA-ULTRA-RK118	REAR LEFT ROOF RACK
17	4	MULE BADGE	MULE LOGO BADGE
18	8	ML-ULTRA-SPREADER	SPREADER
19	16	ML-ULTRA-SPREADER-BRACKET	SPREADER-BRACKET

# HARDWARE

## HARDWARE

ITEM	QTY
Nissan Xterra Mule Ultra Roof Rack	
Front Brace	1
Left Rail	1
Right Rail	1
Rear Brace	1
Front - Cutout or No Cutout	1
Left Side	1
Right Side	1
Rear	1
Front Left Seam Joiner	1
Front Right Seam Joiner	1
Rear Left Seam Joiner	1
Rear Right Seam Joiner	1
Spreader	8
Spreader Bracket	16
<b>A</b> - Mule Ultra SUV Hardware Kit	
1/4"-20 X 1/2" Button Head Bolts	80
1/4"-20 X 3/4" Button Head Bolts	22
1/4"-20 Nylock Nuts	102
5/16"-18 X 3/4" Hex Cap Bolts	8
5/16"-18 X 3/4" Button Head Bolts	38
5/16"-18 X 2 1/2" Button Head Bolts	6
5/16"-18 Nylock Nut	44
5/16"-18 Clip Nut	8
5/16" Flat Washer	16
Roof Mount Hardware Kit	
M6-1.0 X 25mm	12
1/4" - SAE Washers	12
<b>B</b> - Spacer Kit (For Leveling as Needed)	
Round Spacer	10
Tube Spacer	6
Rectangular Spacer	8
Weather Stripping - 63"	1
Foam Pad	1



# RACK ASSEMBLY

---

## ATTENTION

When assembling the Mule Ultra Rack, remember to hand-tighten all bolts relatively loose until the very end of the install. This allows everything to fit into place before everything is tightened down.

## 1 FRONT AND SIDE BRACES MOUNTING

Lay out the front and side braces as shown. Mount the braces together using the 5/16" bolts and nuts.

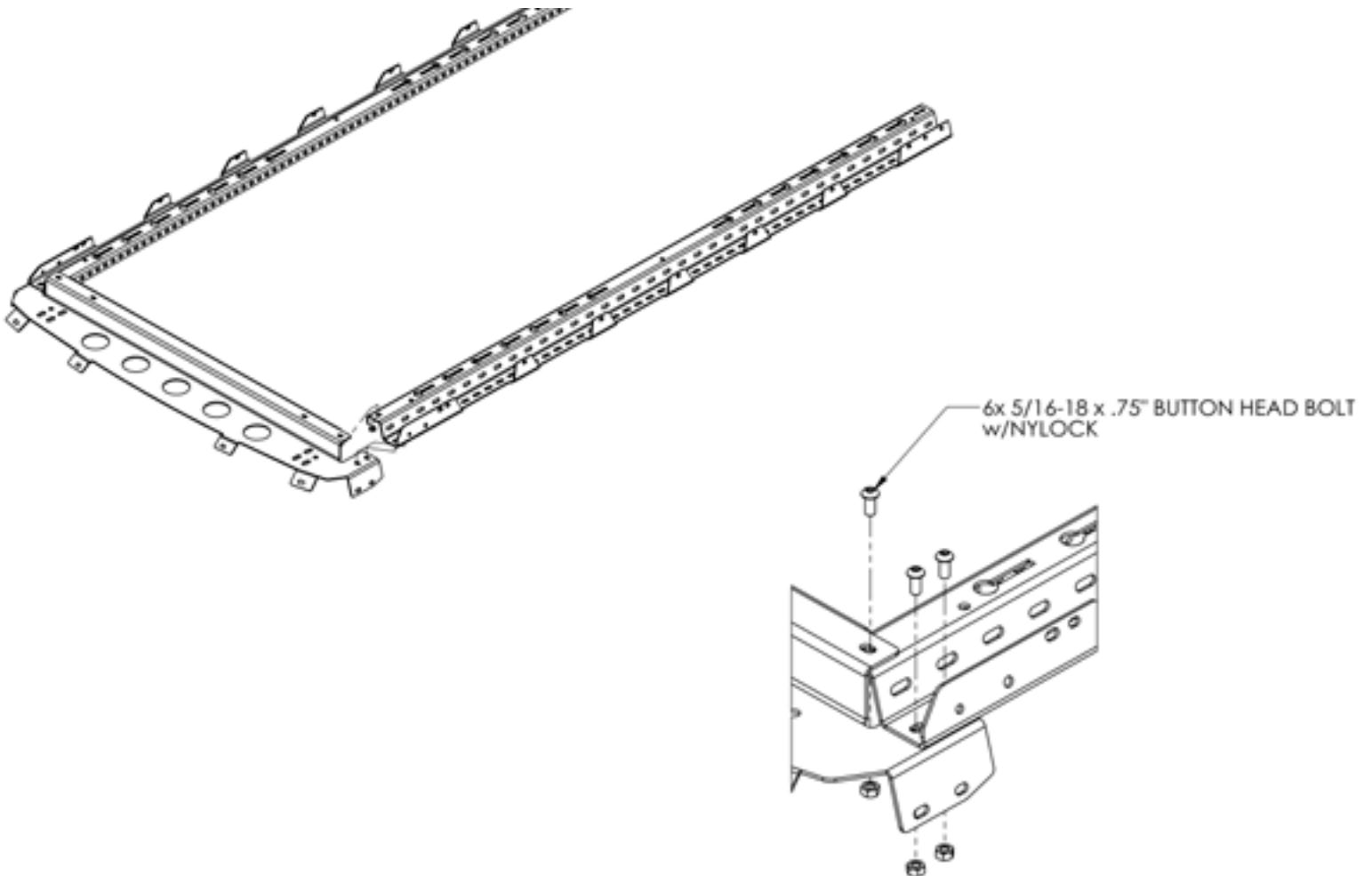

---

## 2 REAR BRACE AND SIDE FASCIA MOUNTING

Attach the rear brace and side fascias shown using 1/4" and 5/16" bolts on both sides as shown below.

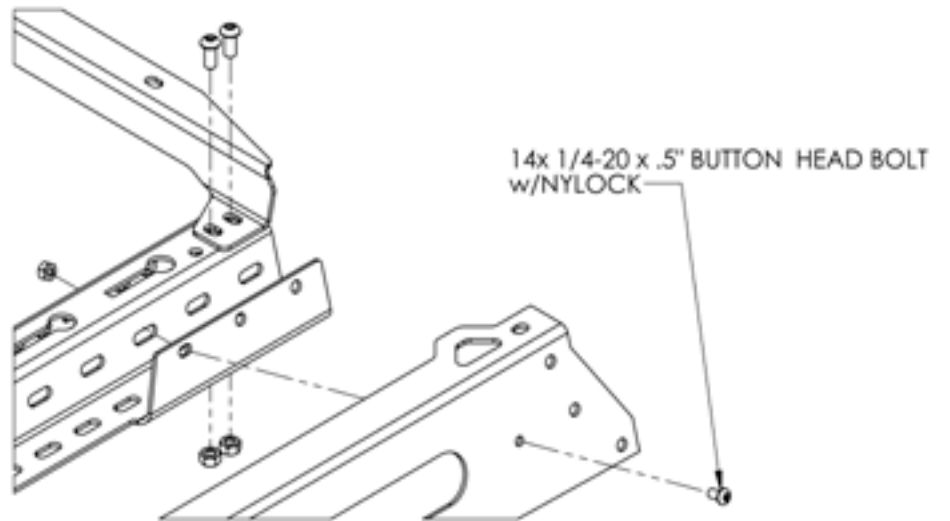
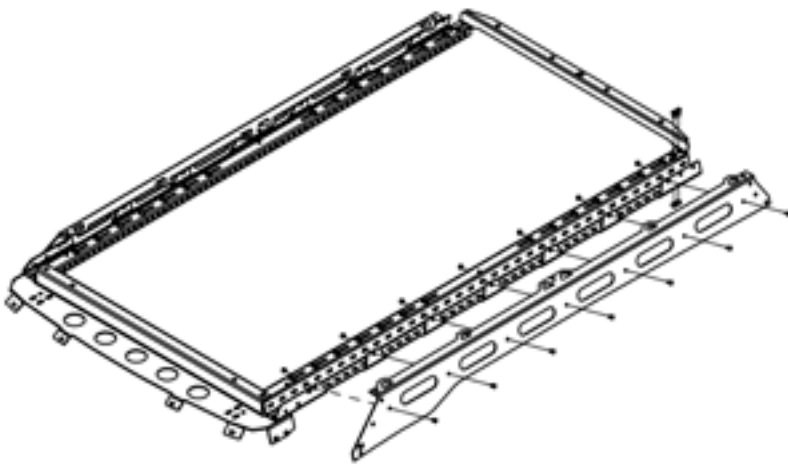

## SIDE FASCIA CONTINUED

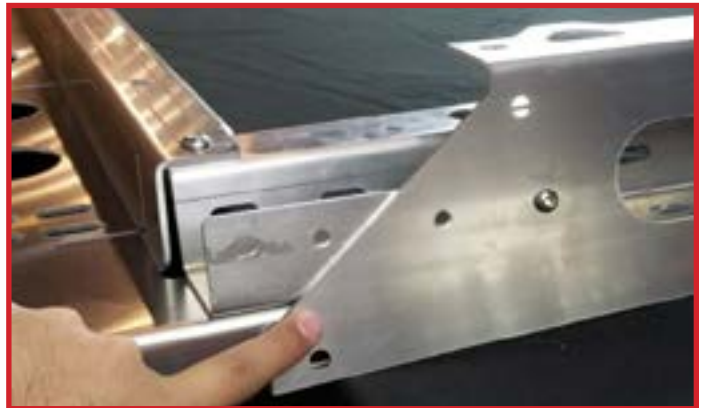

## 3 REAR FASCIA MOUNTING

Attach rear fascia as shown with 5/16" bolts and nuts.

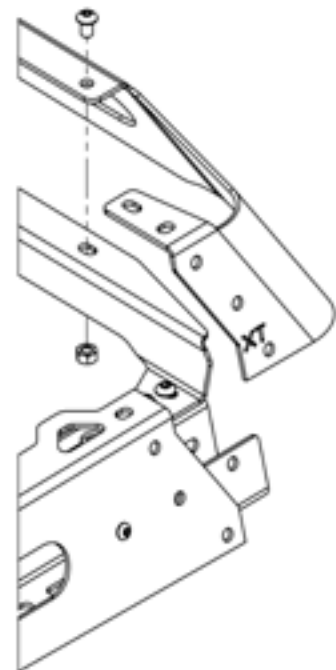

---

## 4 FRONT FASCIA MOUNTING

Attach the front fascia using 1/4" bolts. Use the provided round spacers to adjust the front fascia to match the curve of the roof when test fitting the roof rack during mounting.

NOTE: IF YOU HAVE A FASCIA WITH A LIGHT BAR CUTOUT, WE RECOMMEND INSTALLING THE LIGHT BAR PRIOR TO MOUNTING THE ROOF RACK.

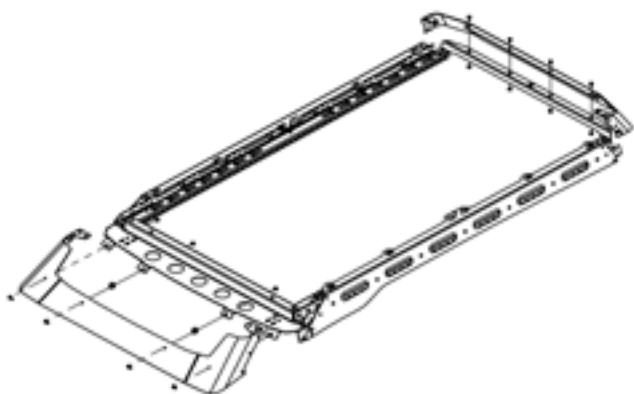

Install the weather stripping to the bottom of front fascia as shown and trim any excess.

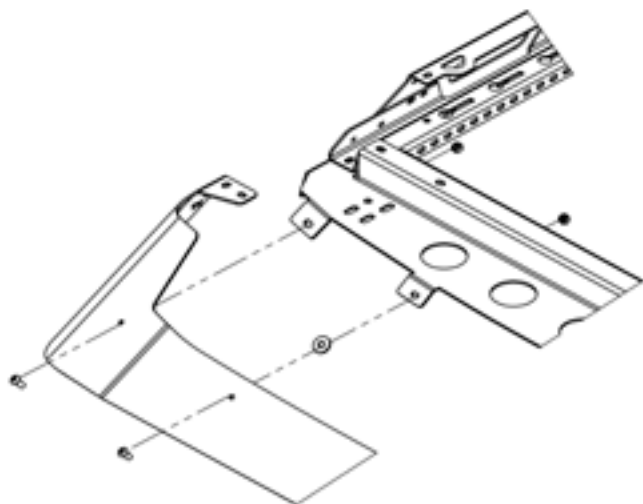



## 5 SEAM JOINERS

Mount both front and rear seam joiners with 5/16" hardware as shown top and bottom.

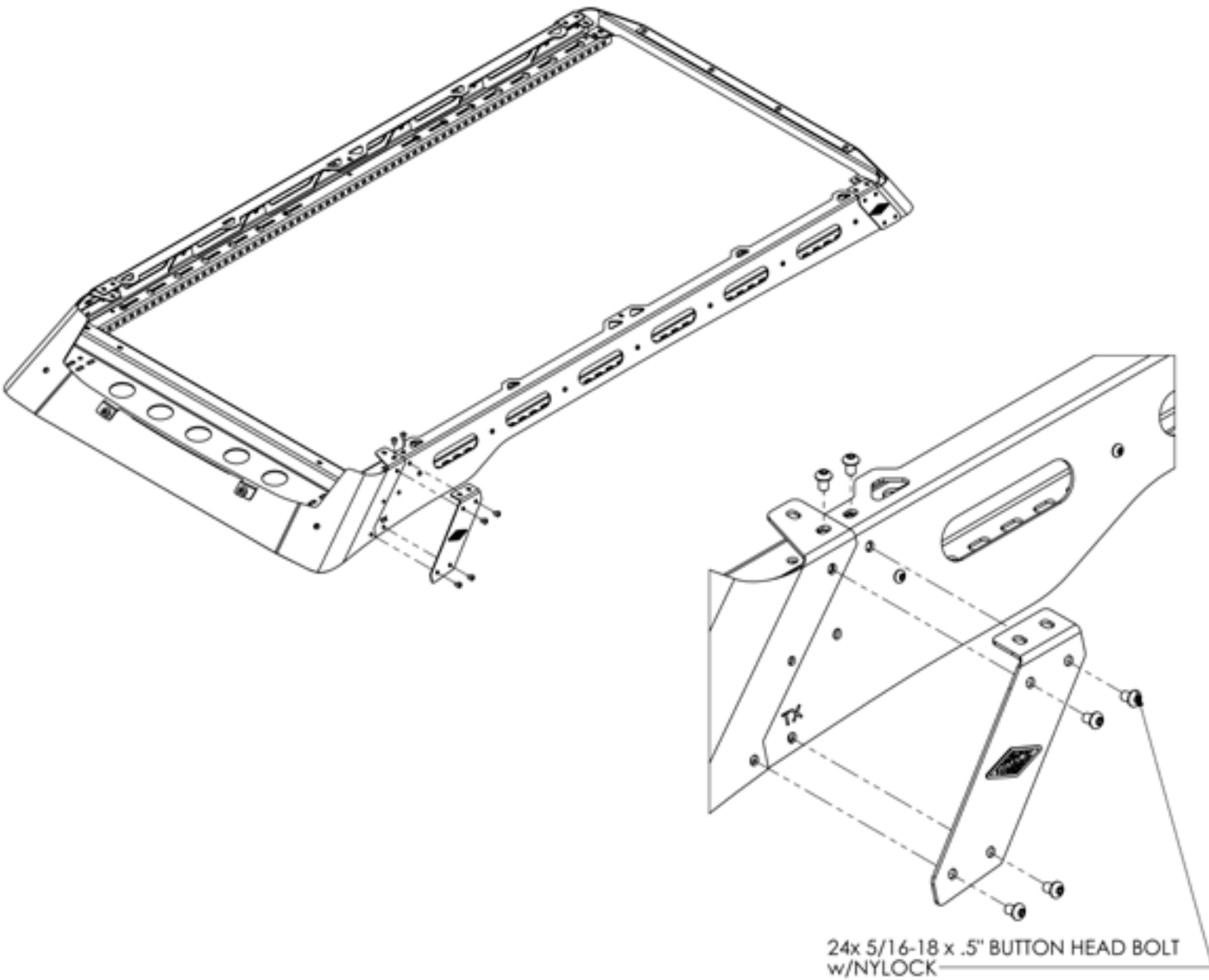

24x 5/16-18 x .5" BUTTON HEAD BOLT  
w/NYLOCK

## 6 REINFORCEMENT SPACERS

Attach reinforcement spacers as shown on all 6 hole locations (3 each side) with the provided hardware.

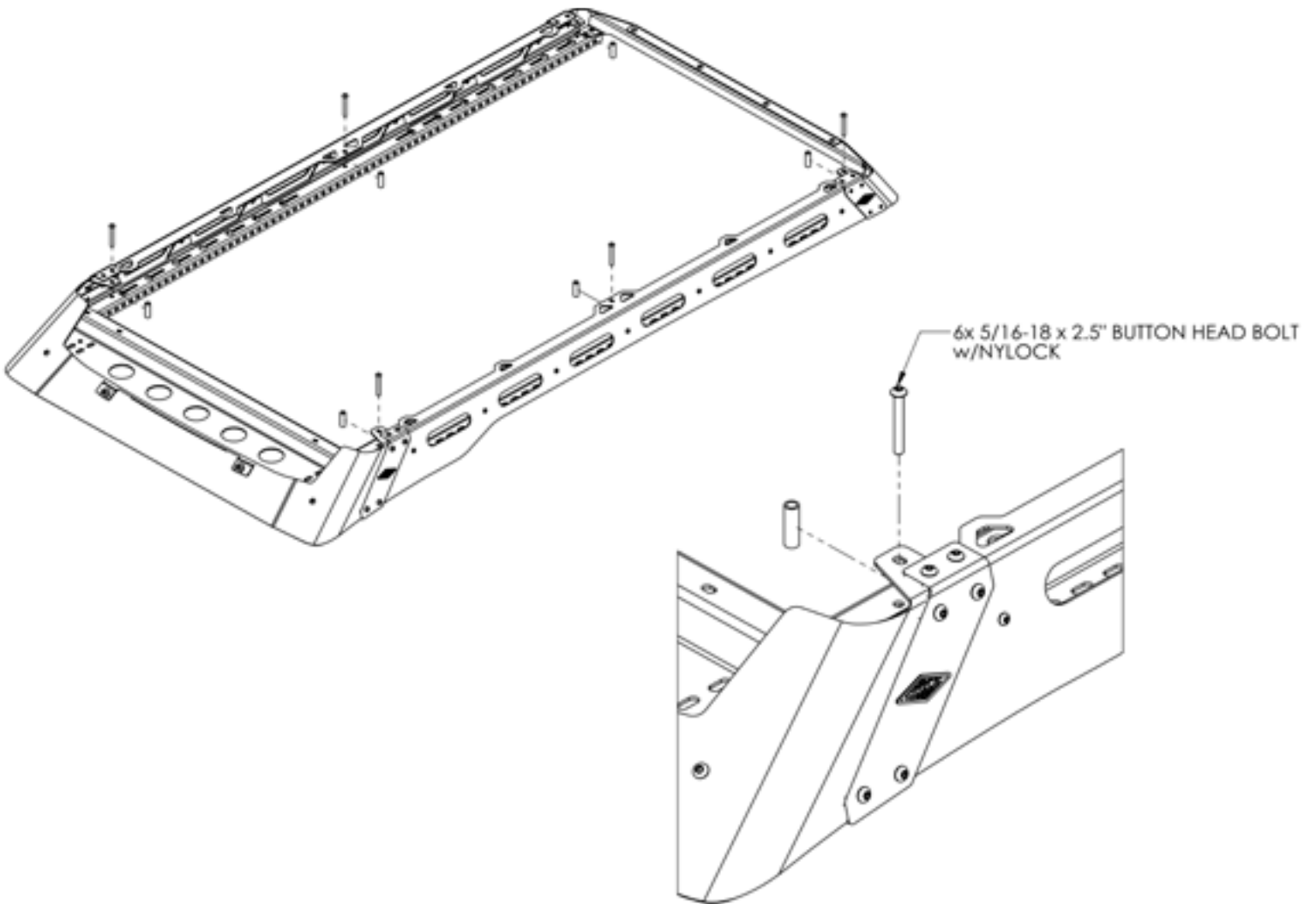

## 7 LOAD BAR ASSEMBLY

Assemble the load bars with the provided mounts using 1/4" bolts and nuts. Repeat for all load bars.



## 8 LOAD BAR INSTALLATION

Flip roof rack over and attach load bars as shown. Using provided nuts and bolts, you may begin tightening down each load bar with two bolts and nylocs for each side.

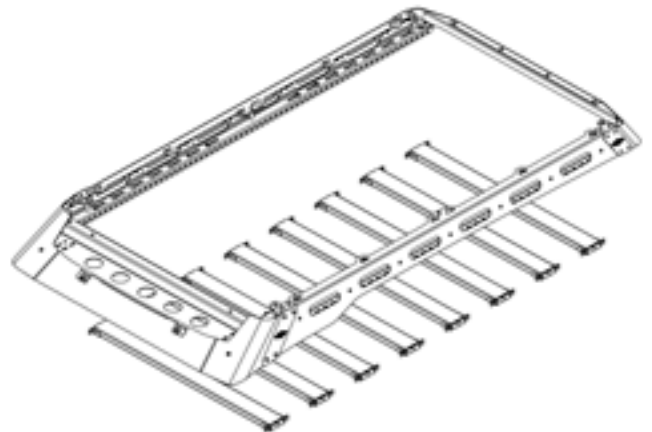
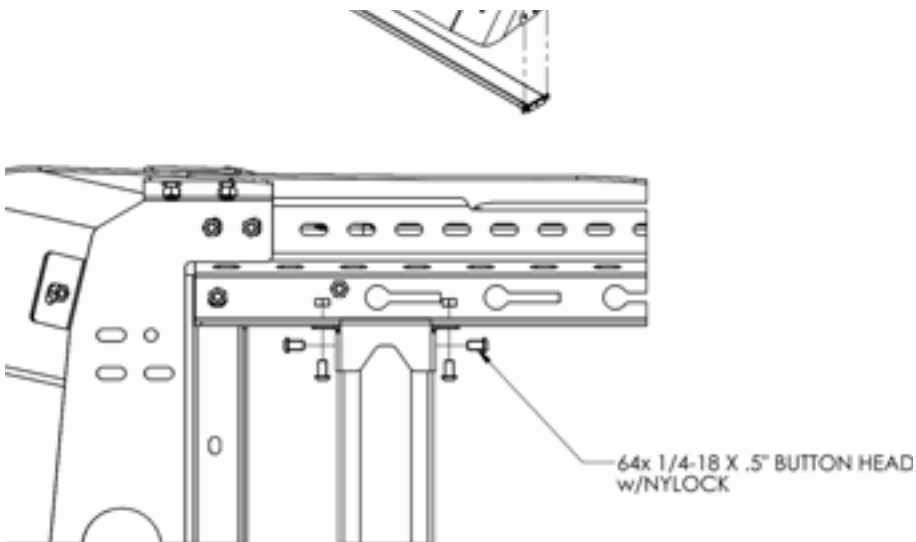

# ROOF RACK INSTALLATION

---

## 9 OEM ROOF RACK REMOVAL

Remove the OEM roof rack. Start by undoing all the hardware at the mount locations and front fascia using the proper trox head. If equipped the front basket may require removal to access hardware. Finally disconnect the roof wiring loom before removing the rack from the vehicle

## 10 MOUNT INSTALLATION

With the provided foam piece, trace each roof mount to create padding for the roof. Leave a small overlap boarder on each peice. Once completed stick the foam piece to each roof mount. Place the front mounts (shown below in the first two photos) at the front of the roof in the factory hole locations. Then place the rear mounts ( shown below in the last two photos) at rear of the roof in the the factory hole locations. Attach the roof mounts using the provided M6 bolts and 1/4" washershardware. Leave the mounts loose for ajustment once the roof rack is in place. Tighten all hardware once the rack is installed.



# ROOF RACK INSTALLATION

## 11 ROOF RACK MOUNTING

Place the roof rack onto vehicle with help of a friend and align with each bracket. Use provided 5/16" bolts and washers for each mount hole location and tighten down roof rack to each bracket as shown below. Use the provided spacer kit to level and adjust the roof rack.

