

INSTALLATION GUIDE

NATO+ACCESSORY TRI-MOUNT

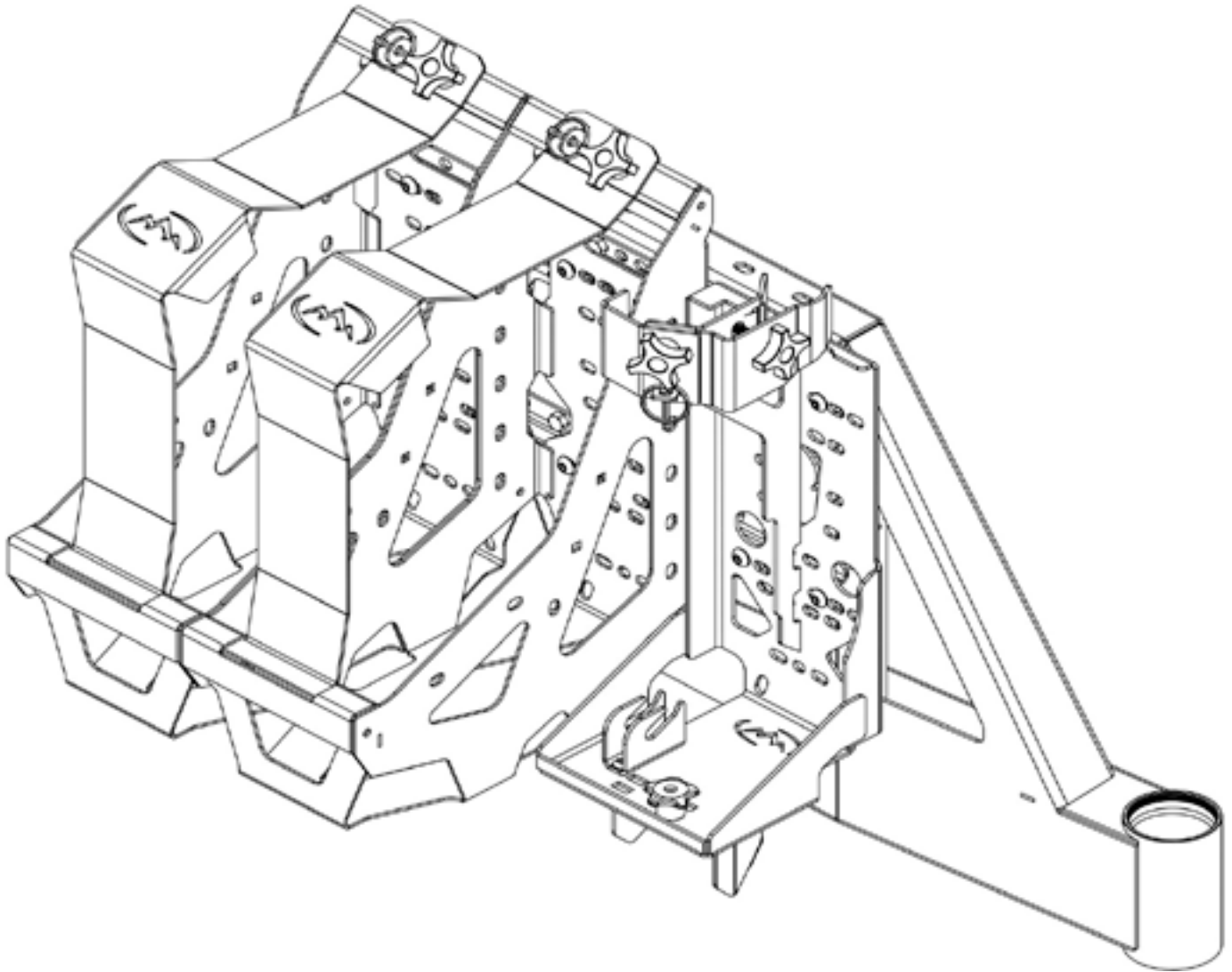

CONTENTS

CONTENTS

Contents and Hardware	Page 2
Non 4Runner DSTC Tri-Mount	
Mounting Hardware	Page 3
NATO Cans and Accessory Mounting	Page 4
Attaching to Swing Arm	Page 5
Connecting NATO Cans	Page 6
4Runner DSTC Tri-Mount	
Mounting Hardware	Page 7
NATO Cans and Accessory Mounting	Page 8
Attaching to Swing Arm	Page 9
Connecting NATO Cans	Page 10
Tri-Mount Assemblies	Page 11

HARDWARE

ITEM	QTY
Tri-Mount Bars	2
Accessory Mounting Hardware	
3/8"-16 X 3/4" Button Head Bolts	12
3/8"-16 Nylock Nuts	12
Tri-Mount Hardware	
3/8"-16 X 1" Hex Cap Bolts	16
3/8"-16 Nylock Nuts	16
Nato Can Attachment Hardware	
(Provided With Supplied Hardware For 2 NATO Cans)	
1/4"-20 X 3/4" Hex Cap Bolts	2
1/4"-20 Nylock Nuts	2

NOTE

The Tri-Mount bar is designed to work without washers and therefore not included in the provided hardware.

It is not recommended that hi-lift jack and/or pullpal mounts be mounted as the furthest outside accessory to avoid excessive weight and/or momentum on the arm. We also highly recommend that water and fuel can accessories should only be carrying full capacity when in use on offroad trips and not used as long-term storage on your vehicle.

SKILL LEVEL - 2 STARS



1 STAR

EASY - No tools required

2 STARS

BASIC - Requires standard tools, basic mechanical knowledge and understanding

3 STARS

MODERATE - Requires standard tools. Some drilling and/or cutting.

4 STARS

ADVANCED - Requires speciality tools. Drilling, cutting, and/or welding

5 STARS

EXPERT - Professional installation recommended.

DISCLAIMER

Expedition One is not responsible for any damages to vehicle or injury.

We always recommend professional assistance when installing our vehicle products.

Always follow safety precautions including the use safety gear and devices.

NON 4RUNNER DSTC TRI-MOUNT

1 TRI-MOUNT AND SWING ARM MOUNTING HARDWARE

Pre insert the provided hardware as shown for mounting the tri-mount to the swing arm in step 3. Hardware placement and location will depend upon the swing arm type. Choose locations that best fit your swing arm and preference.

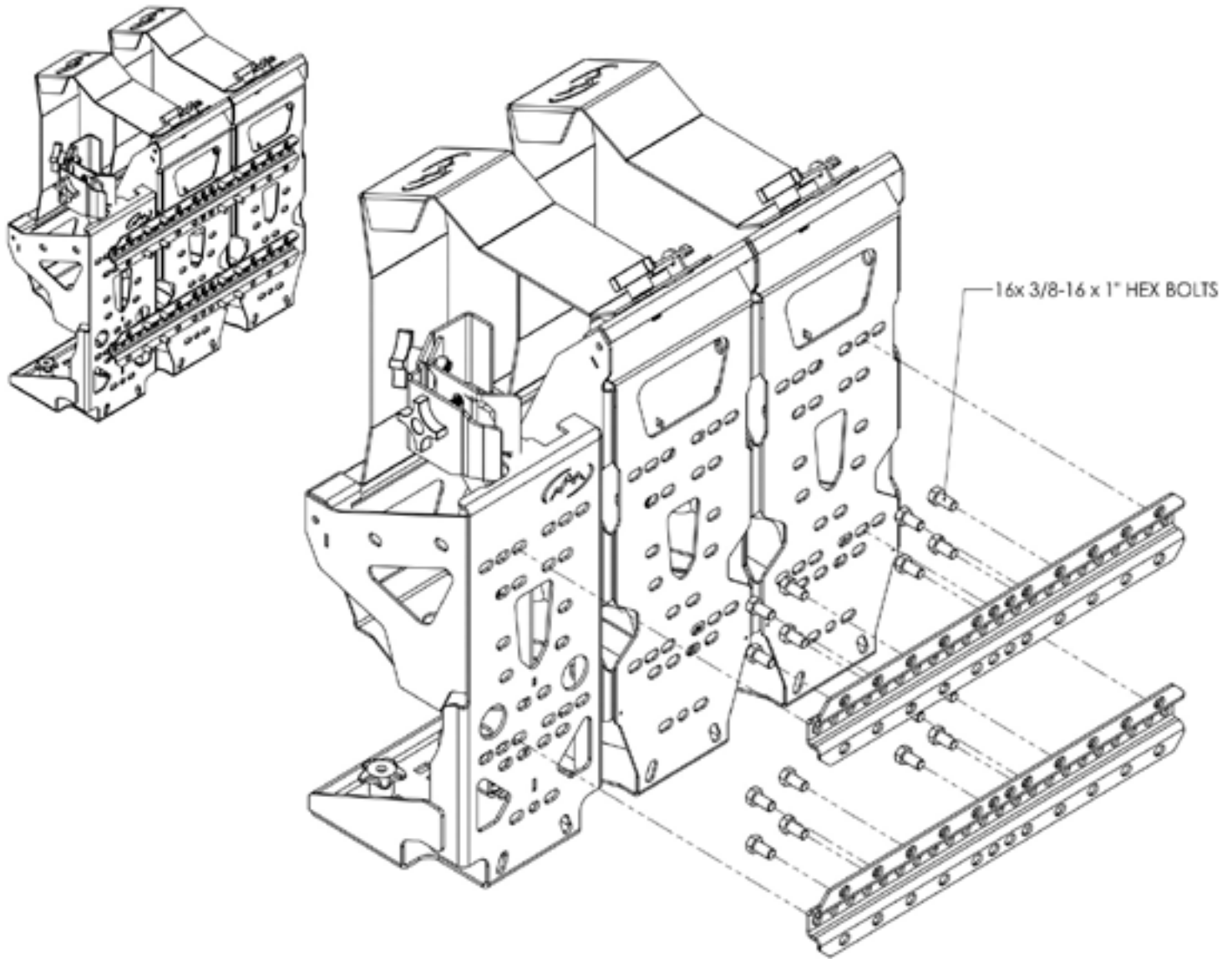

2 MOUNTING NATO CANS AND ACCESSORIES

Attach both the nato cans and accessory to the tri-mount bars using the hardware shwon below.

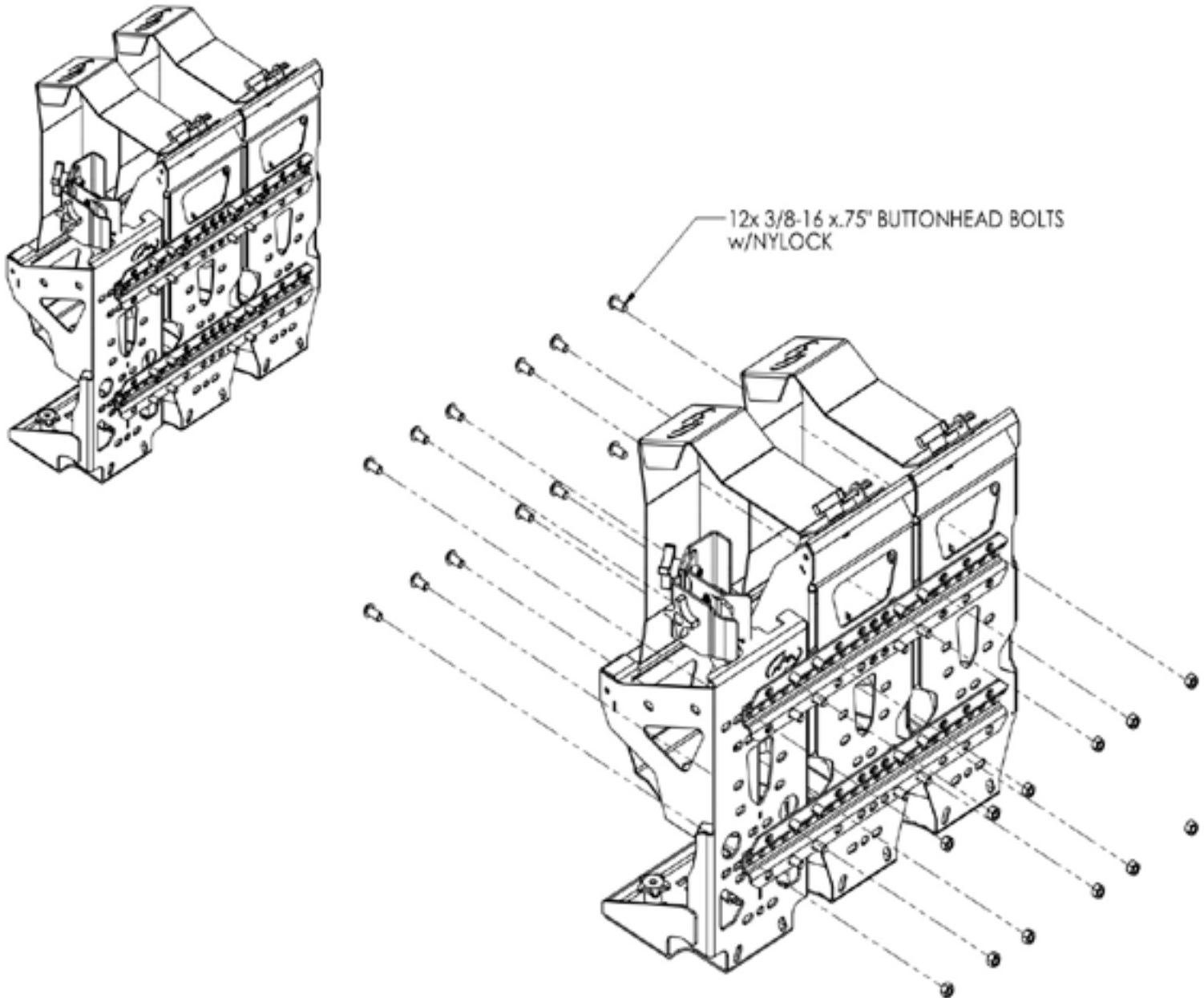

3 SWING ARM MOUNTING

Mount the tri-mount to the swing arm as shown below from step 2.

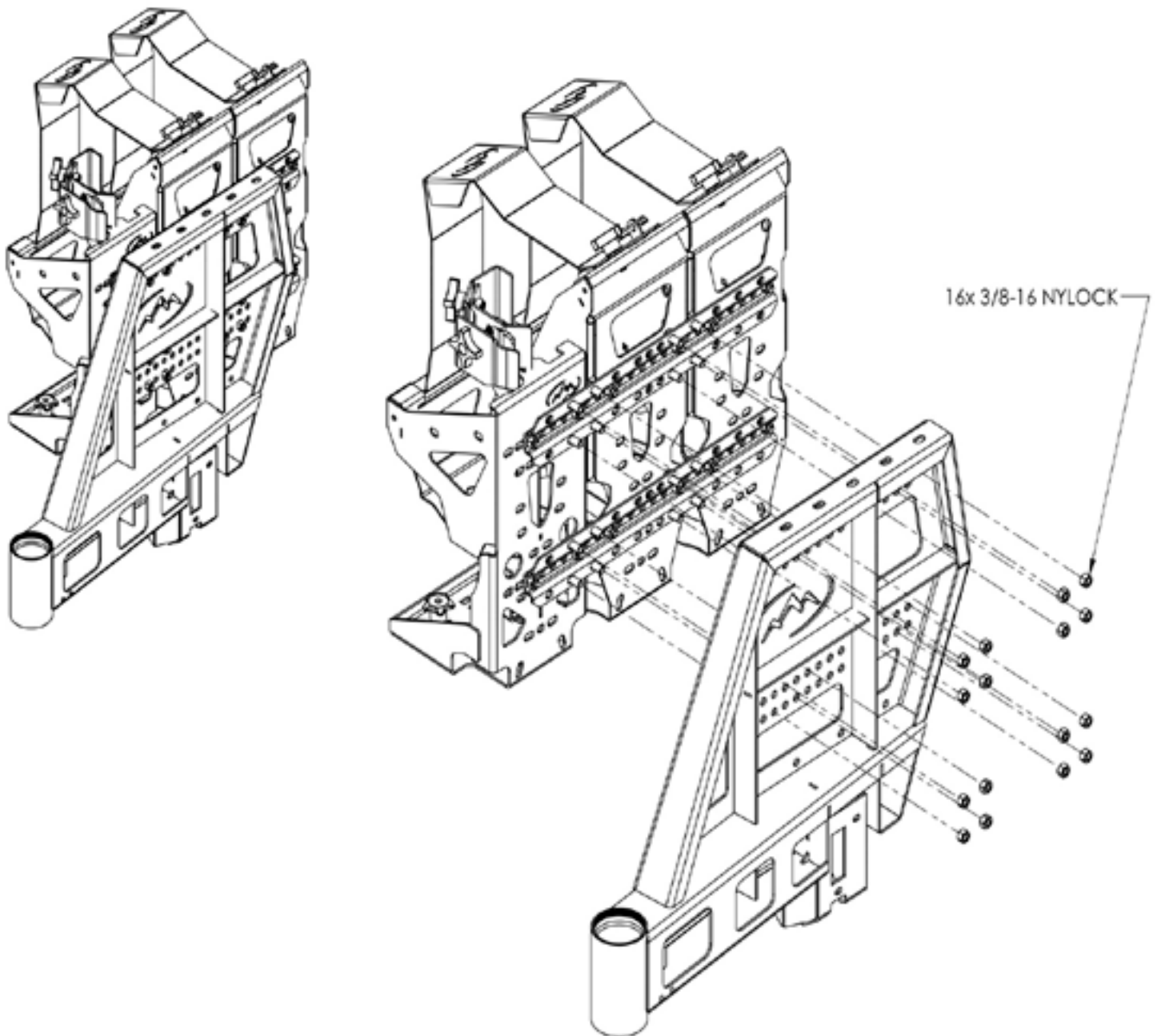

4 CONNECT NATO CANS

Mount the nato cans to each other using the provided hardware in the locations as shown below.

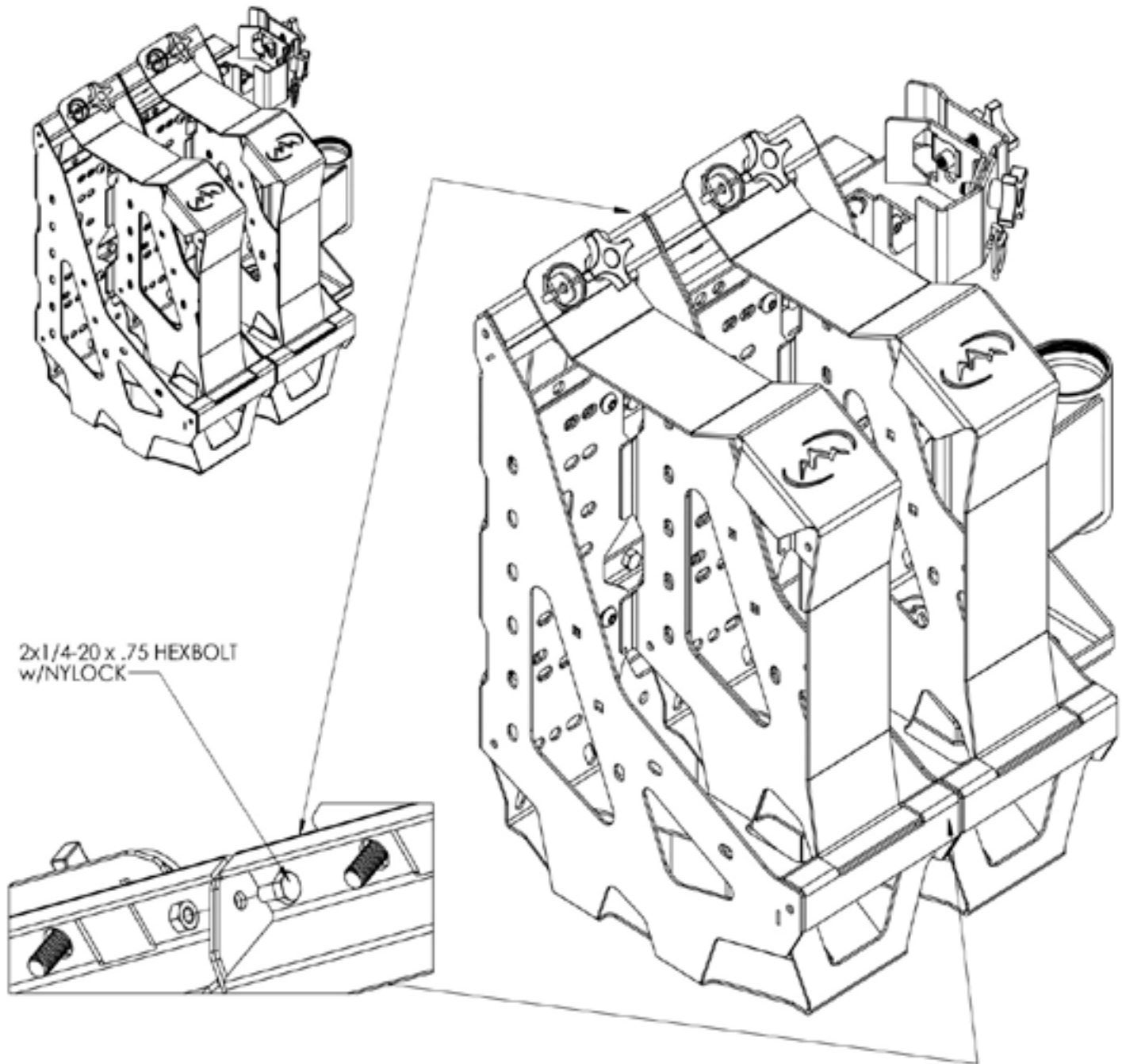

4RUNNER DSTC TRI-MOUNT

1 TRI-MOUNT AND SWING ARM MOUNTING HARDWARE

Pre insert the provided hardware as shown for mounting the tri-mount to the swing arm in step 3.

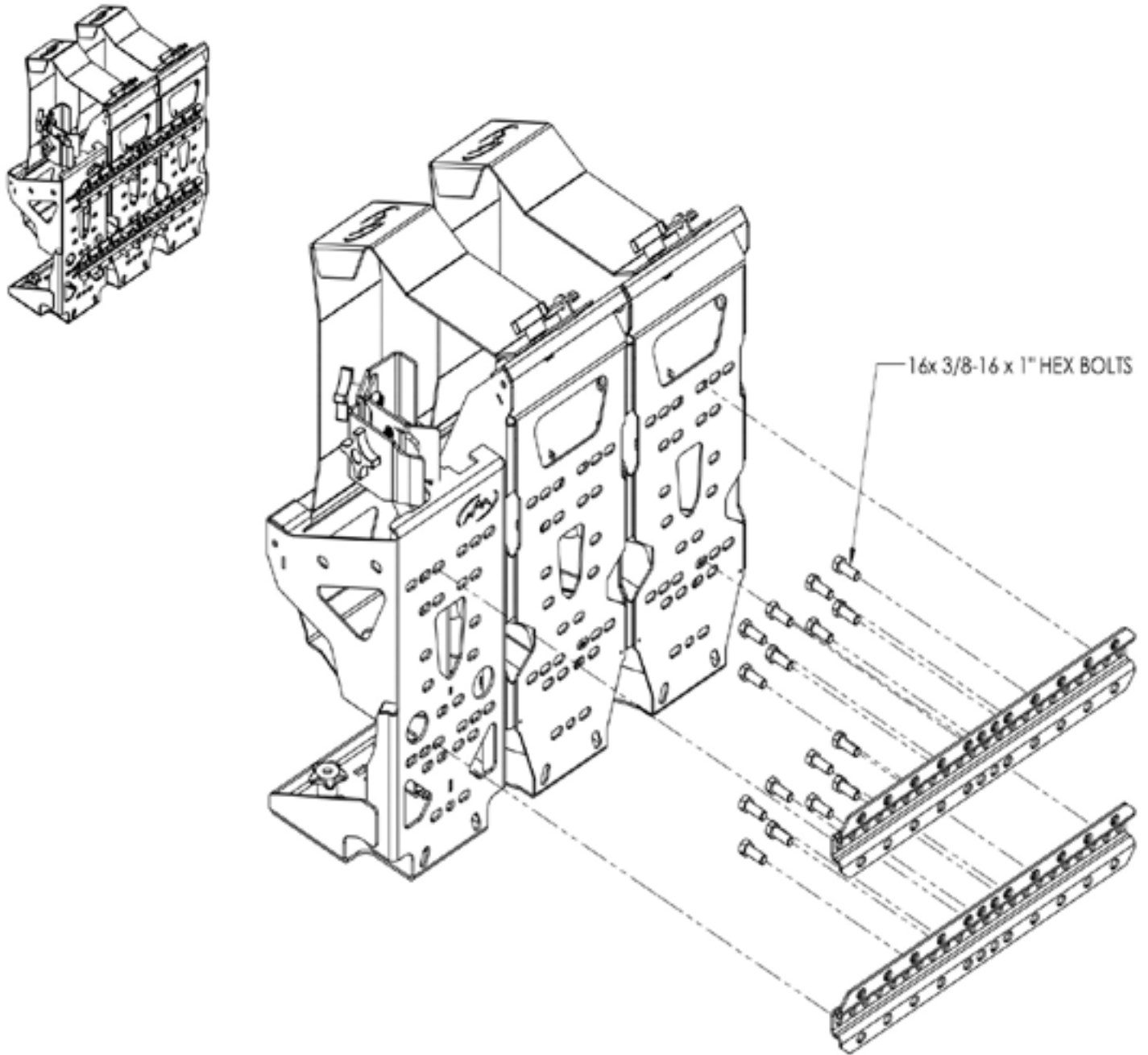

2 MOUNTING NATO CANS AND ACCESSORY

Attach both the nato cans and accessory to the tri-mount bars using the hardware shwon below.

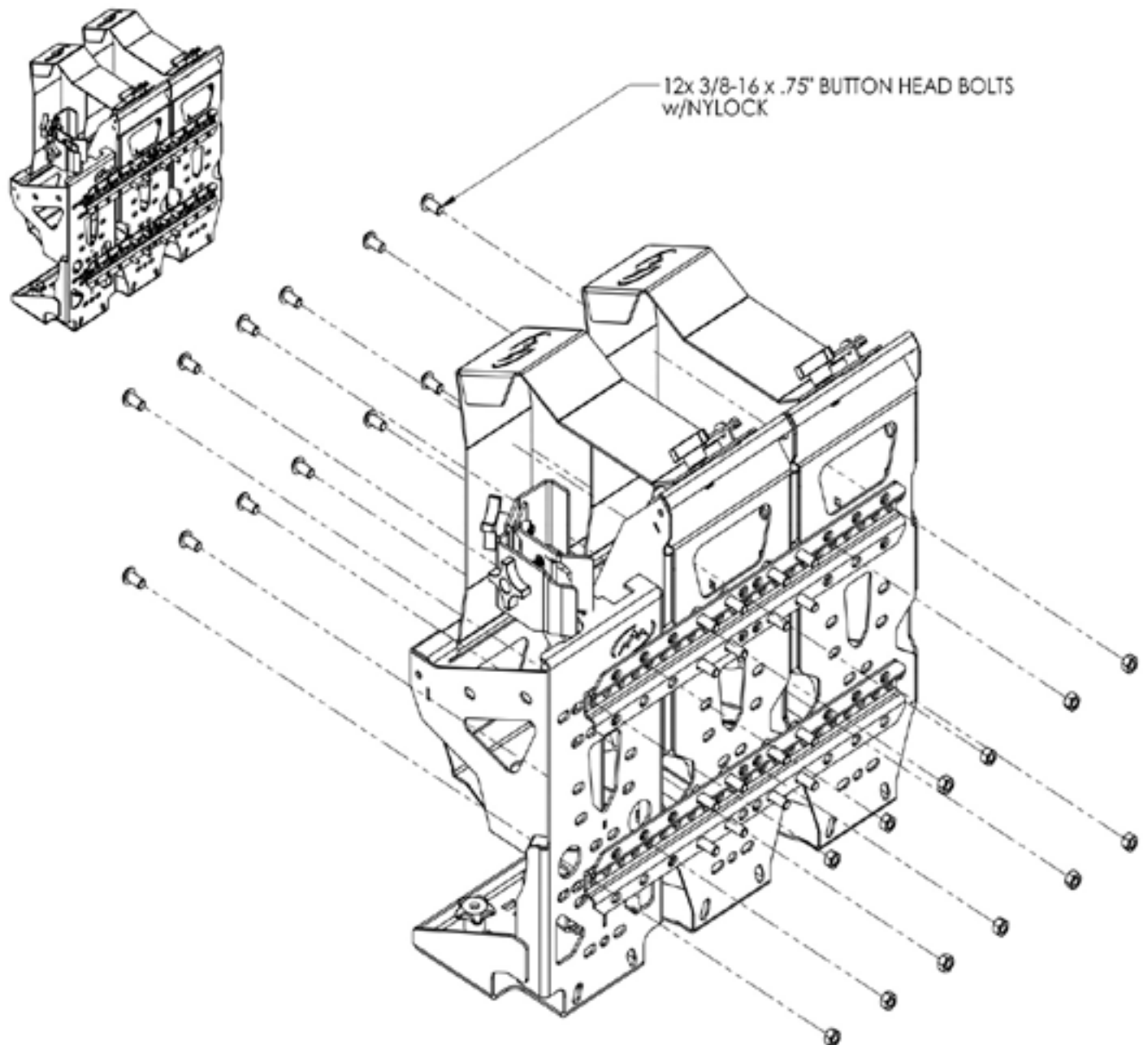

3 SWING ARM MOUNTING

Mount the tri-mount to the swing arm as shown below from step 2.

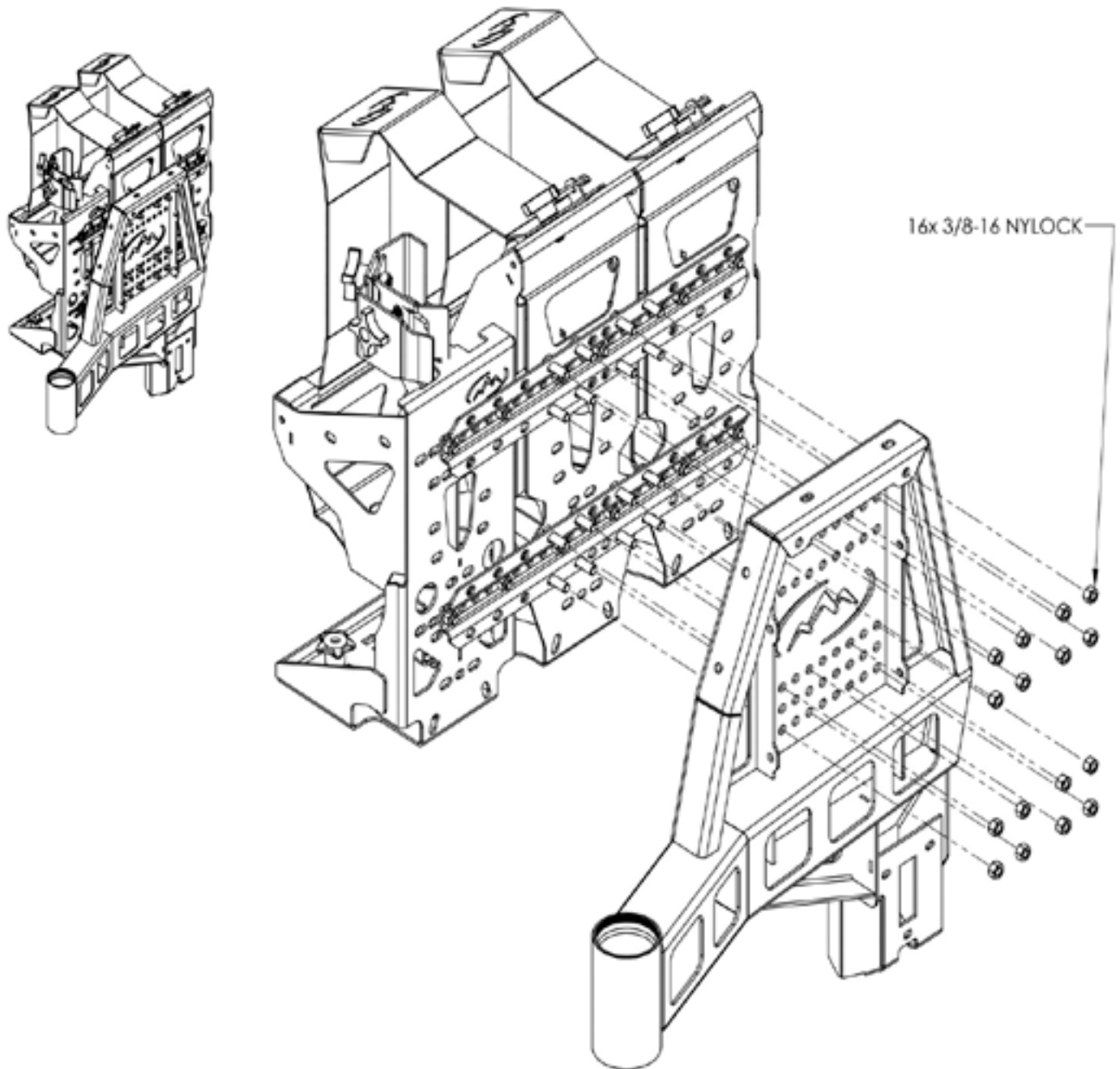

4 CONNECT NATO CANS

Mount the nato cans to each other using the provided hardware in the locations as shown below.

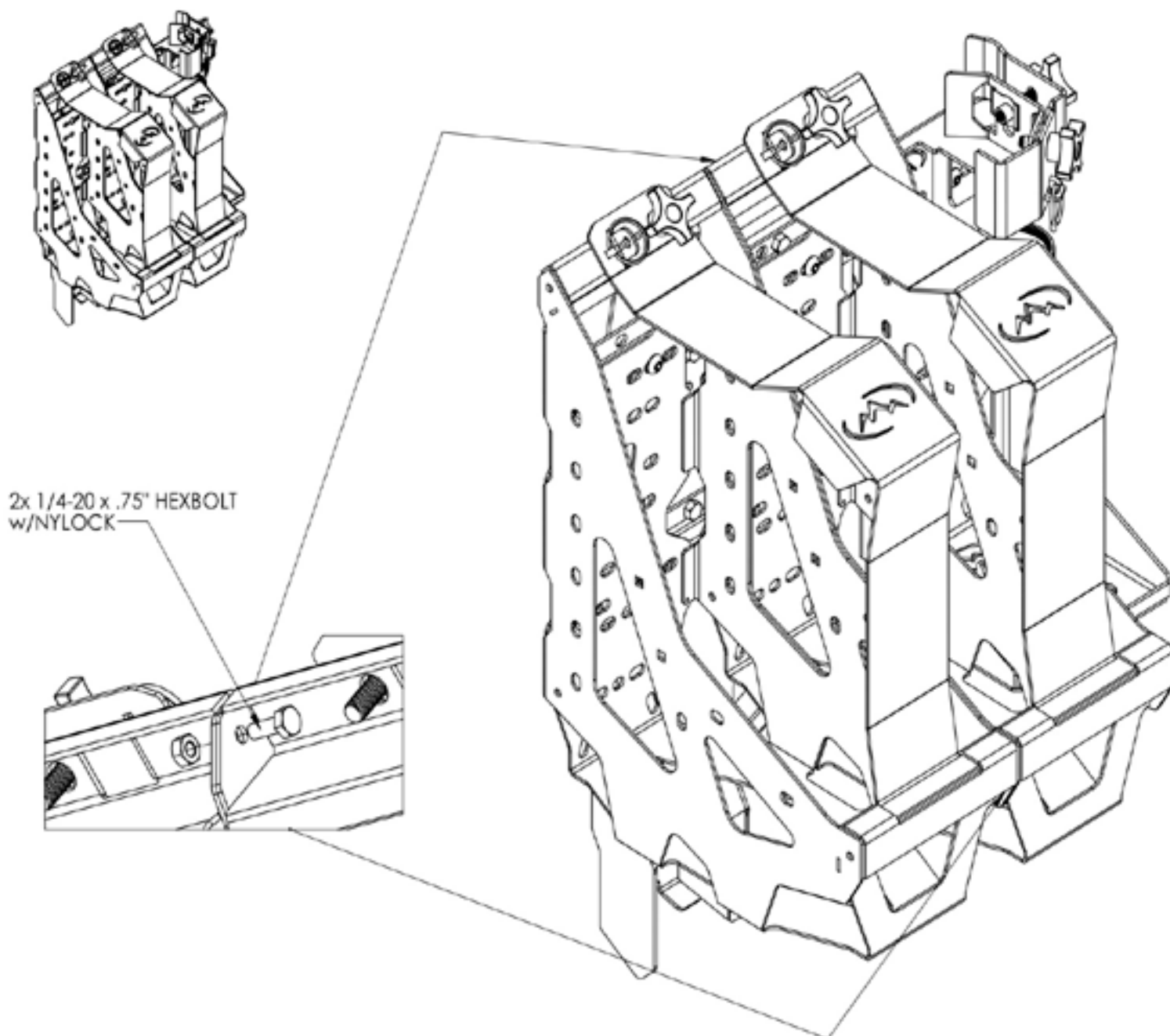

NON 4RUNNER DSTC

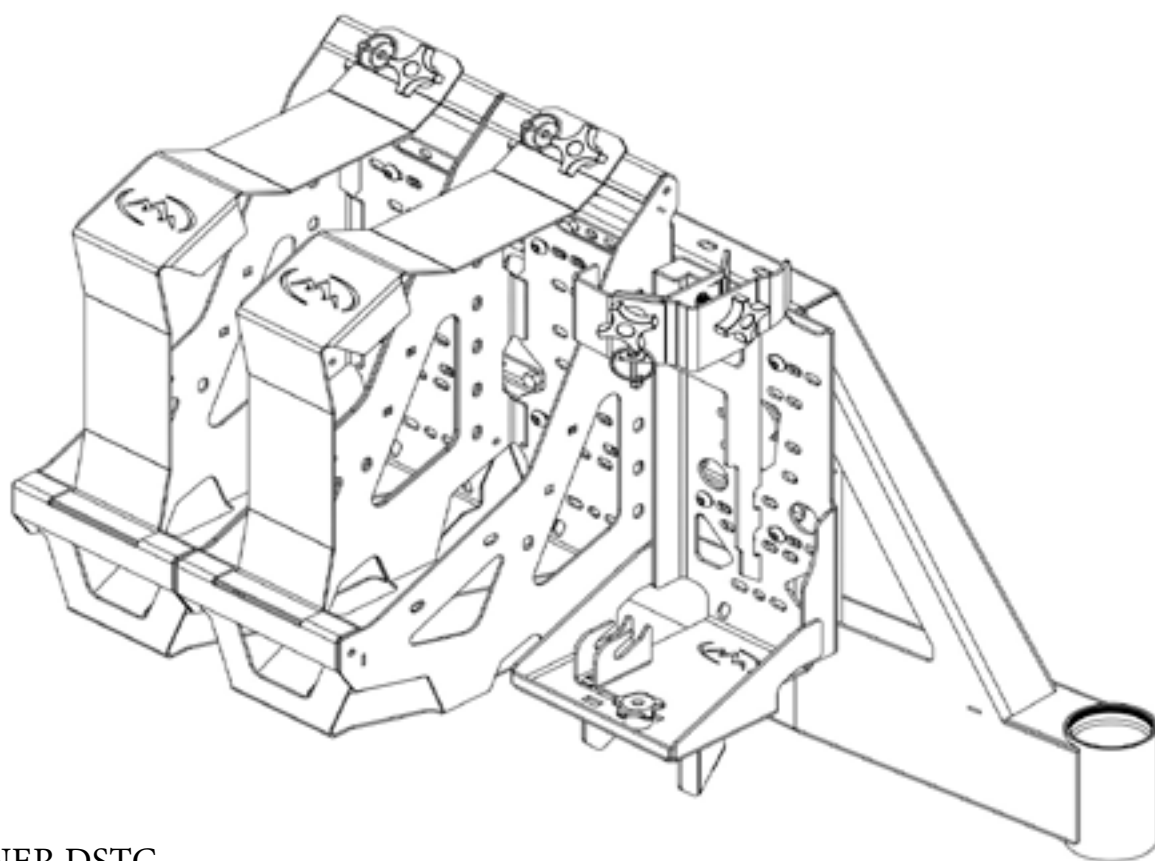

4RUNNER DSTC

