

# INSTALLATION GUIDE

Ford Ranger Mule Ultra Rack



# CONTENTS

---

Roof Rack Diagram	Page 3
Hardware	Page 4
Roof Rack Assembly	
Brace Assembly	Page 5
Side and Rear Fascia Mounting	Page 6
Rear Seam Joiners and Front Fascia	Page 7
Front Seam Joiners and Spacers Install	Page 8
Load Bar Assembly	Page 9
Roof Mount Installation	
Seat Belt Disassembly	Page 10
Grab Handle Removal	Page 11
Sun Visor and Weather Stripping	Page 12
Roof Trim Hardware	Page 13
Roof Trim Removal	Page 14
Drilling Roof Mounts	Page 15-16
Riv Nut Installation	Page 16-17
Reassembly and Roof Mount Install	Page 18
Roof Rack Installation	
Installation and Mounting of Roof Rack	Page 19

## SKILL LEVEL - 4 STARS



1 STAR	★☆☆☆☆
2 STARS	★★☆☆☆
3 STARS	★★★☆☆
4 STARS	★★★★☆
5 STARS	★★★★★

EASY - No tools required
BASIC - Requires standard tools, basic mechanical knowledge and understanding
MODERATE - Requires standard tools. Some drilling and/or cutting.
ADVANCED - Requires speciality tools. Drilling, cutting, and/or welding
EXPERT - Professional installation recommended.

## DISCLAIMER

Expedition One is not responsible for any damages to vehicle or injury.  
We always recommend professional assistance when installing our vehicle products.

Always follow safety precautions including the use safety gear and devices.

### NOTE

Due to the nature of aluminum, rack pieces including fascia parts may require time to “relax” or return to shape before mounting. Do not force parts into place. Leave all hardware loose before tightening to allow for adjustment.

# MULE ULTRA RACK

---

A

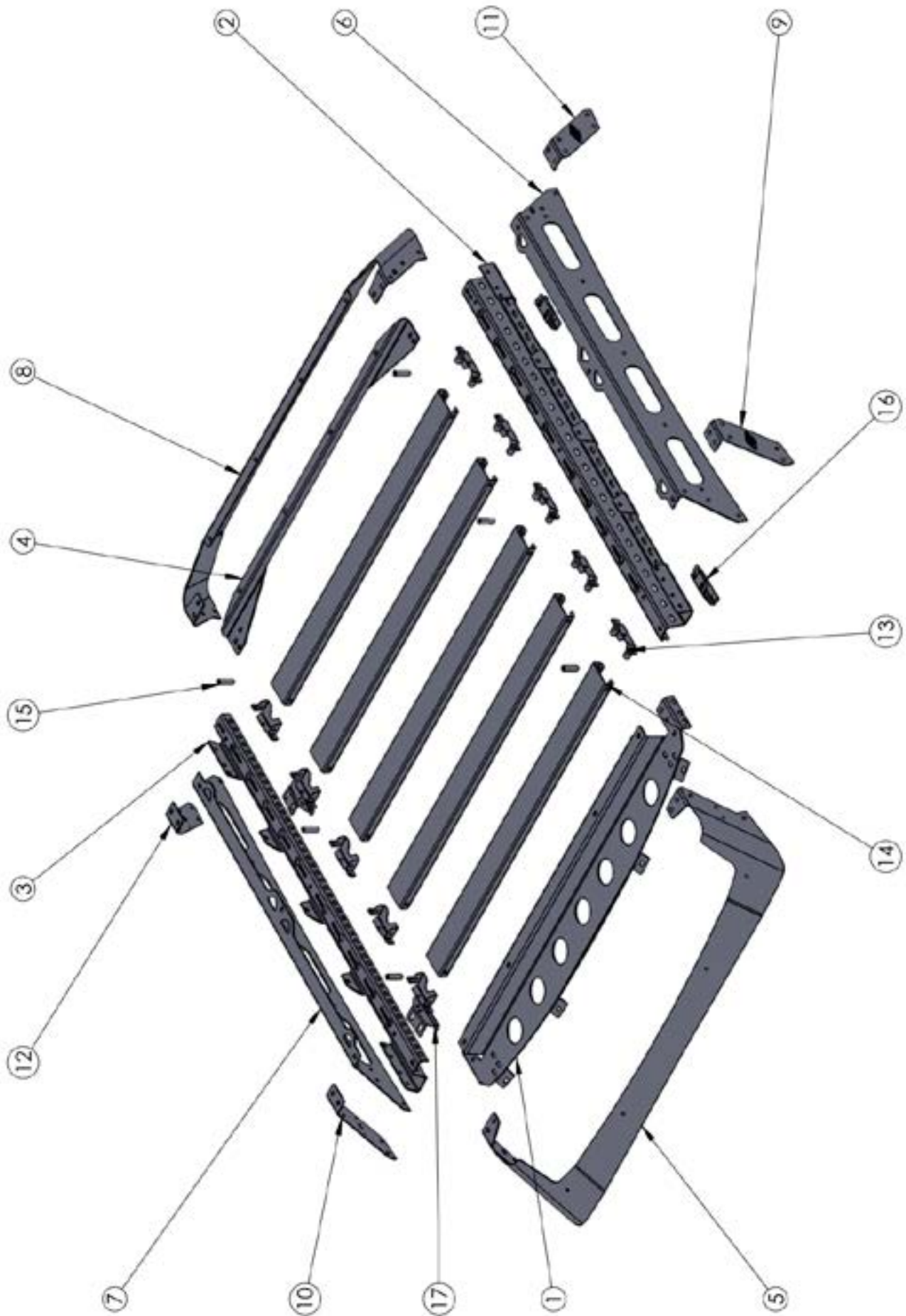

# HARDWARE

## HARDWARE

ITEM QTY

**A - Ford Ranger Mule Ultra Roof Rack**

1	Front Brace	1
2	Left Rail	1
3	Right Rail	1
4	Rear Brace	1
5	Front - Cutout or No Cutout	1
6	Left Side	1
7	Right Side	1
8	Rear	1
9	Front Left Seam Joiner	1
10	Front Right Seam Joiner	1
11	Rear Left Seam Joiner	1
12	Rear Right Seam Joiner	1
13	Spreader Bracket	10
14	Spreader	5
15	Spacer Tube	6
16	Roof Mount Bracket	2
17	Roof Mount Bracket Opposite	2



**B - Mule Ultra Truck Hardware Kit**

1/4"-20 X 1/2"	Button Head Bolts	16
1/4"-20 X 3/4"	Button Head Bolts	48
1/4"-20	Nylock Nuts	64
5/16"-18 X 3/4"	Hex Cap Bolts	8
5/16"-18 X 3/4"	Button Head Bolts	38
5/16"-18 X 2 1/2"	Button Head Bolts	6
5/16"-18	Nylock Nut	44
5/16"	Flat Washer	8

**C - Riv Nut Hardware Kit**

1/4"-20 X 3/4"	Hex Cap Bolts	8
1/4"-20 X 2"	Hex Cap Bolt	1
1/4"-20 X 3/8"	Riv Nut	8
1/4" X 0.625"	SAE Washers	10
1/4"	Serrated Crimp Washer	1
3/8" X 1.125"	Coupler Nut	1
	Riv Nut Crimp Tool	1

**D - Spacer Kit (For Leveling as Needed)**

	Round Spacer	10
	Rectangular Spacer	8

**E - Weather Stripping - 63"** 1

**E - Foam Stripping - 18"** 1

# RACK ASSEMBLY

---

## ATTENTION

When assembling the Mule Ultra Rack, remember to hand-tighten all bolts relatively loose until the very end of the install. This allows everything to fit into place before everything is tightened down.

## 1 FRONT AND SIDE BRACES MOUNTING

Lay out the front and side braces as shown. Mount the braces together using the 5/16" bolts and nuts.

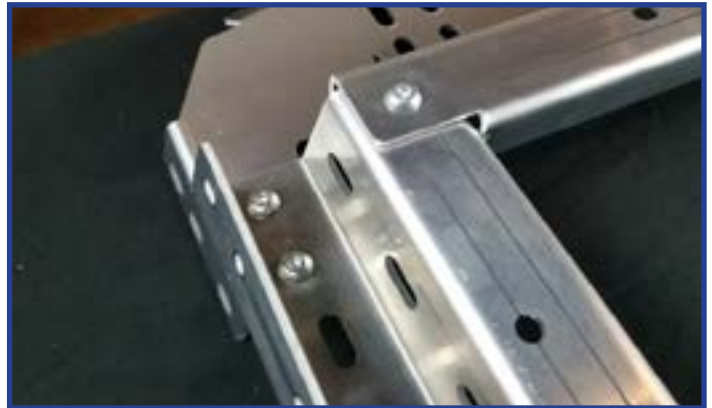

## 2 REAR BRACE MOUNTING

Attach the rear brace as shown using 5/16" bolts on both sides.



---

### 3 SIDE FASCIA MOUNTING

Mount both side fascias as shown using 1/4" bolts. The shallow angle should face the front of the roof rack.

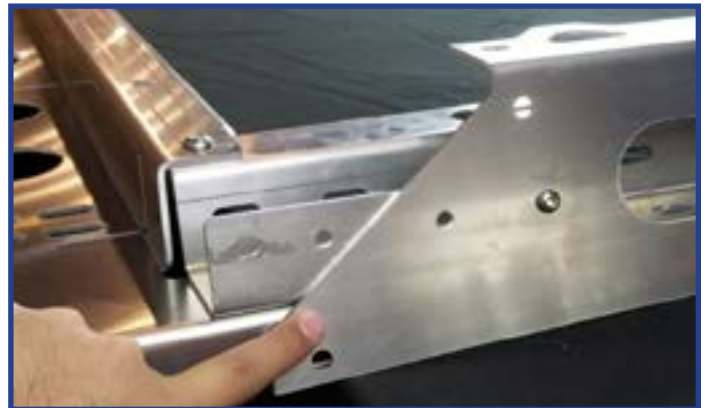

### 4 REAR FASCIA MOUNTING

Attach rear fascia as shown with 5/16" bolts and nuts.

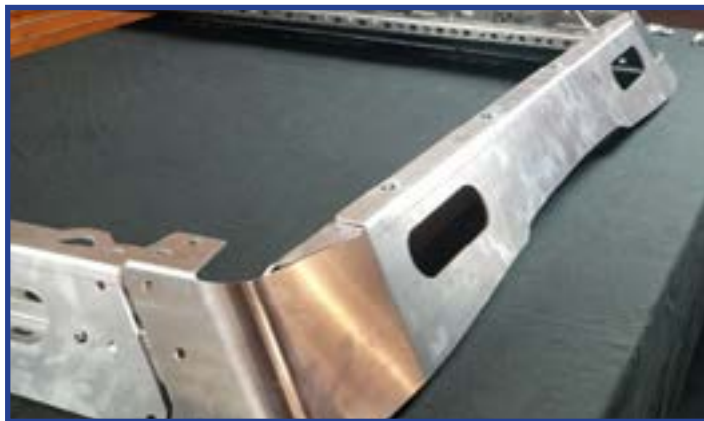

---

## 5 REAR SEAM JOINERS

Mount both rear seam joiners with 5/16" bolts as shown top and bottom.



## 6 FRONT FASCIA MOUNTING

Attach the front fascia using 5/16" bolts, along with a single spacer piece for each hole.

NOTE: IF YOU HAVE A FASCIA WITH A LIGHT BAR CUTOUT, WE RECOMMEND INSTALLING THE LIGHT BAR PRIOR TO INSTALLING THE FASCIA.

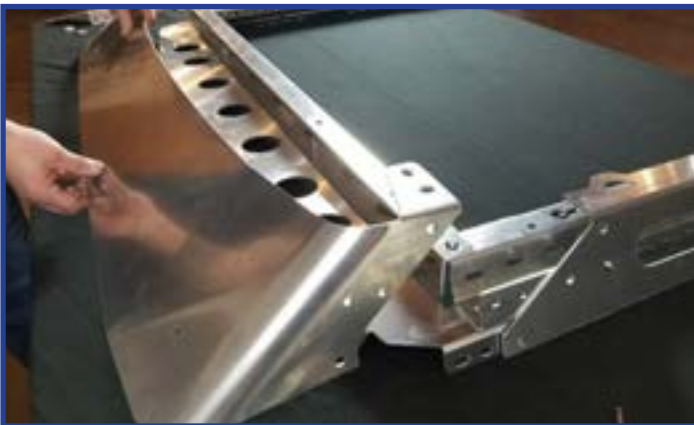

Install the weather stripping to the bottom of front fascia as shown right and trim any excess.



---

## 7 FRONT SEAM JOINERS

Mount both front seam joiners with 5/16" bolts as shown top and bottom.

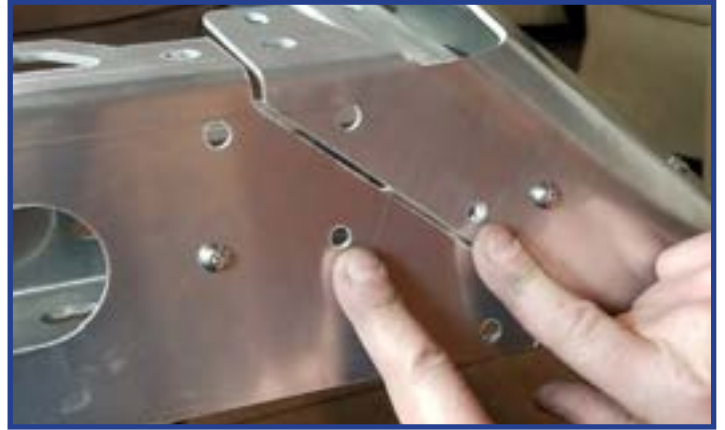

## 8 REINFORCEMENT SPACERS

Attach reinforcement spacers as shown on all 6 hole locations (3 each side) with provided bolts and nuts.

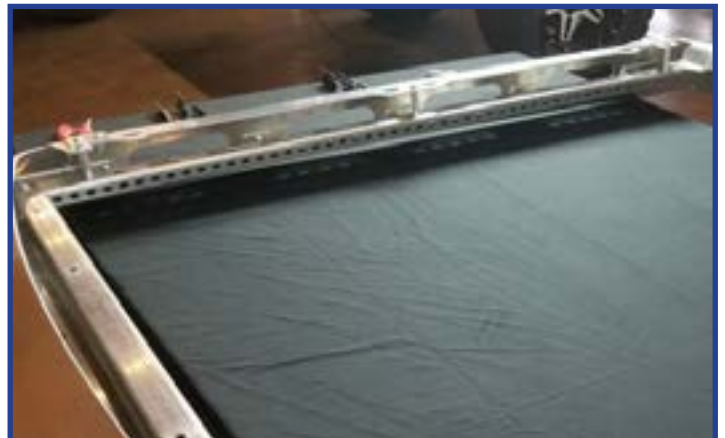



---

## 9 LOAD BAR ASSEMBLY

Assemble the load bars with the provided mounts using 1/4" bolts and nuts. Repeat for all load bars.



## 10 LOAD BAR INSTALLATION

Flip roof rack on its back and attach load bars into desired locations as shown in photo. Using provided nuts and bolts, you may begin tightening down each load bar with two bolts/nuts for each side of load bars as shown.

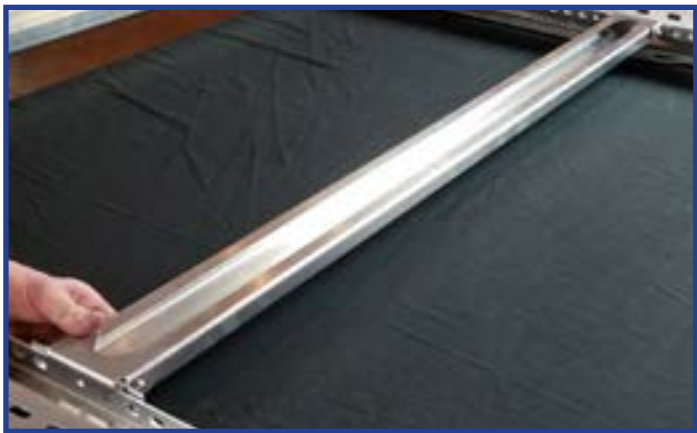

# INSTALLATION OF ROOF RACK MOUNTS

---

## 11 FRONT SEAT BELT REMOVAL

Remove the cover and unbolt the front seat belt. Repeat on the other side.



## 12 REAR SEAT BELT REMOVAL

Remove both rear seat belt covers and unbolt the rear seat belts.



---

## 13 FRONT GRAB HANDLE REMOVAL

Remove both covers and unbolt the hardware to remove the handle. Repeat on the other side.



## 14 ROOF GRAB HANDLE REMOVAL

Remove both covers and unbolt the handles for both sides of the vehicle.



---

## 15 FRONT SUN VISOR REMOVAL

Remove the cover and unbolt the hardware to remove the visor. Repeat on the other side.



## 16 WEATHER STRIPPING

Pull the weather stripping away from the top of all doors to access the headliner.



---

## 17 FRONT ROOF TRIM HARDWARE REMOVAL

Offset the headliner (we used a pop bottle to hold the head liner back) to gain access to the front roof trim hardware located as shown. Remove the nut on each side. WATCH FOR WIRING.



## 18 REAR ROOF TRIM HARDWARE REMOVAL

Repeat the same procedure to remove the rear roof hardware as located below for both sides. WATCH FOR WIRING.



---

## 19 ROOF TRIM REMOVAL

Use a trim tool to slide under the roof trim to cut the double sided tape, repeat on both sides. Remove the roof trim and both front roof trim bolts.



## 20 REAR ROOF TRIM HARDWARE

Replace the small rear bolts back on the roof trim rail to make it easier for assembly later.



---

## 21 FRONT MOUNT DRILLING

Use this arrow as your first mount hole location, measuring 12" from the front windshield glass.  
Measure to 14 1/8" for the 2nd mount point and mark the locations. Drill both sides  
We recommend using a Center Punch tool and pre drilling the holes. WATCH FOR WIRING.



---

## 22 REAR MOUNT DRILLING

From the front of windshield glass measure to 50 1/8" for the 1st mount and 52 1/4" for the 2nd mount. Mark the locations and drill each hole on both sides.

We recommend using a Center Punch tool and pre drilling the holes. WATCH FOR WIRING.



## 23 RIV NUT INSTALLATION

Using a riv nut tool shown to right, place the provided riv nuts into the holes and lock into place with the riv nut tool. We recommend adding some sealant around the holes to provide more weather resistance from the elements.





---

## RIV NUT INSTALLATION CONTINUED

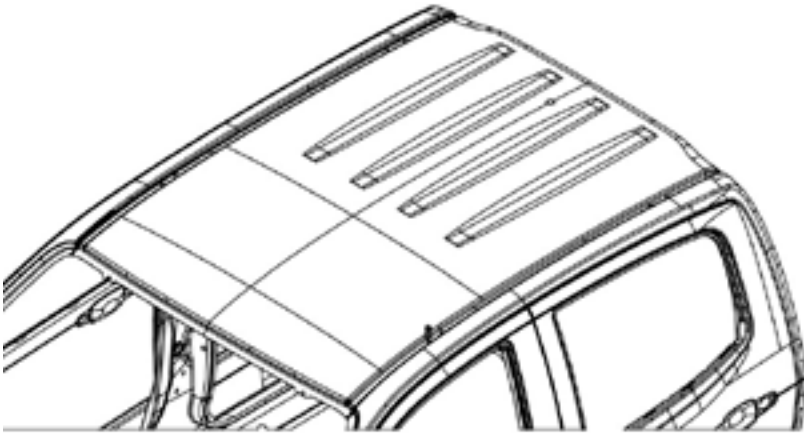

USE RIVET NUT TOOL OR INCLUDED TOOL TO  
INSERT RIVETS IN DRILLED HOLES.  
SEAL EDGES WITH WATERPROOF SEALANT

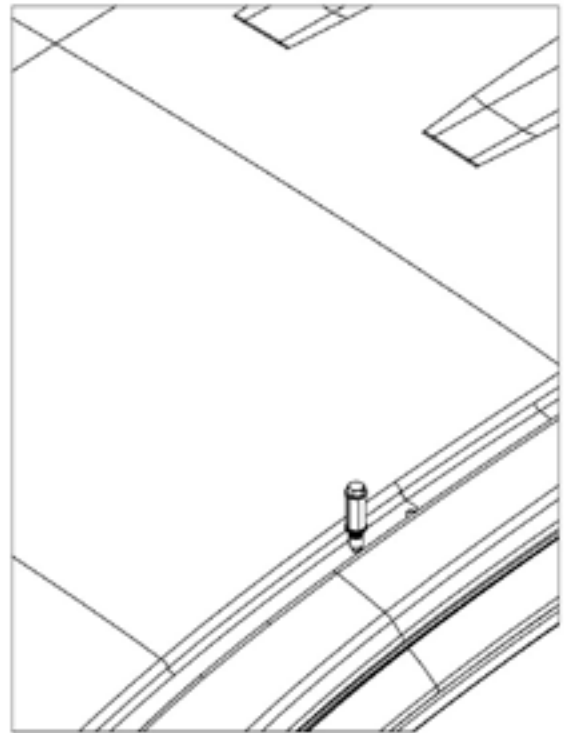
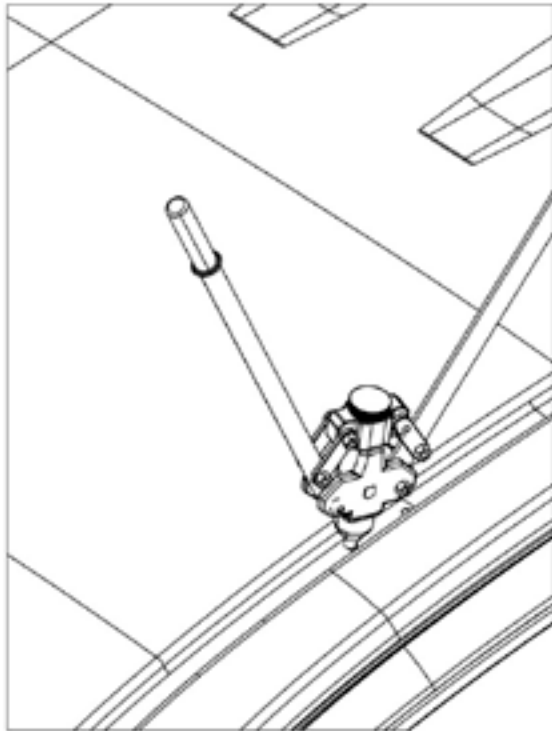

---

## 24 TRIM MODIFICATION AND REASSEMBLY

Mark the roof trim using the same measurements from steps 21 and 22. Drill the holes to match the riv nut locations. Once done reinstall the trim and reassemble the interior.



## 25 ROOF MOUNT INSTALLATION

Attach the provided clips onto the support brackets. Place your roof mount brackets into position over the roof trim and tighten down into place with provided hardware.



# ROOF RACK INSTALLATION

---

## 26 ROOF RACK MOUNTING

Place the roof rack onto vehicle with help of a friend and align with each bracket. Use provided 5/16" bolts and washers for each mount hole location and tighten down roof rack to each bracket as shown below. Use the provided spacer kit to level and adjust the roof rack.

