

INSTALLATION GUIDE

DSTC HI LIFT PULL PAL MOUNT

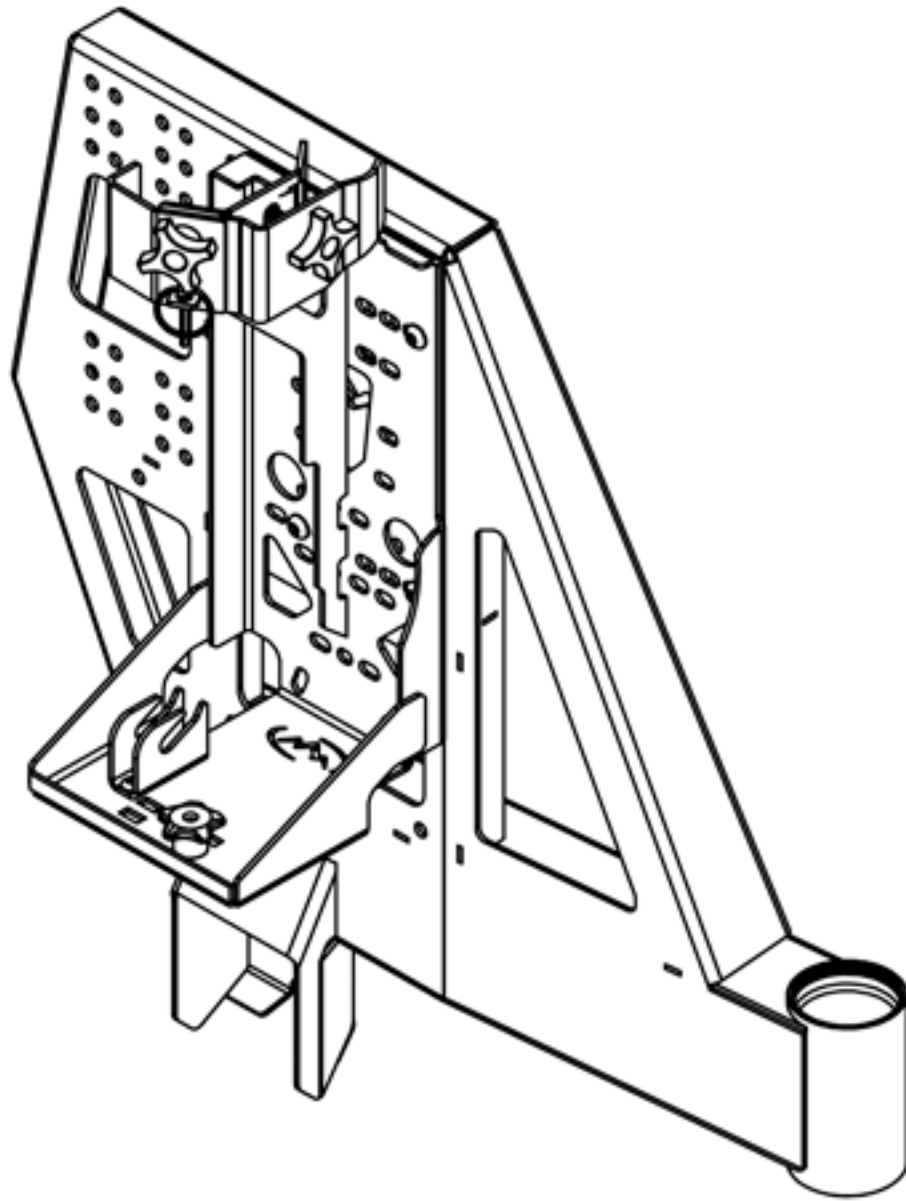

CONTENTS

FOR USE ON DSTC SWING ARMS

HARDWARE

ITEM	QTY
Hi Lift Pull Pal Mount	1
Hardware	
Hi-Lift Pull Pal Plates	3
Hi-Lift Knob	2
Hi-Lift Knob No Thread	1
5/16" - 18 X 3/4" Button Head Bolts	2
5/16" - 18 X 1" Carriage Bolt	1
5/16" - 18 Nyloc Nuts	2
3/8" - 16 Clip Nut	2
Linch Pin	1
3/8"-16 X 1" Button Head Bolt	4
3/8"-16 Nyloc Nut	4
3/8" USS Wssher	4

SKILL LEVEL - 2 STARS



1 STAR

EASY - No tools required

2 STARS

BASIC - Requires standard tools, basic mechanical knowledge and understanding

3 STARS

MODERATE - Requires standard tools. Some drilling and/or cutting.

4 STARS

ADVANCED - Requires speciality tools. Drilling, cutting, and/or welding

5 STARS

EXPERT - Professional installation recommended.

DISCLAIMER

Expedition One is not responsible for any damages to vehicle or injury.
We always recommend professional assistance when installing our vehicle products.

Always follow safety precautions including the use safety gear and devices.

DSTC HI LIFT PULL PAL MOUNT

1 HI LIFT PULL PAL MOUNT

Assemble the Hi Lift Pull Pal Mount as shown.

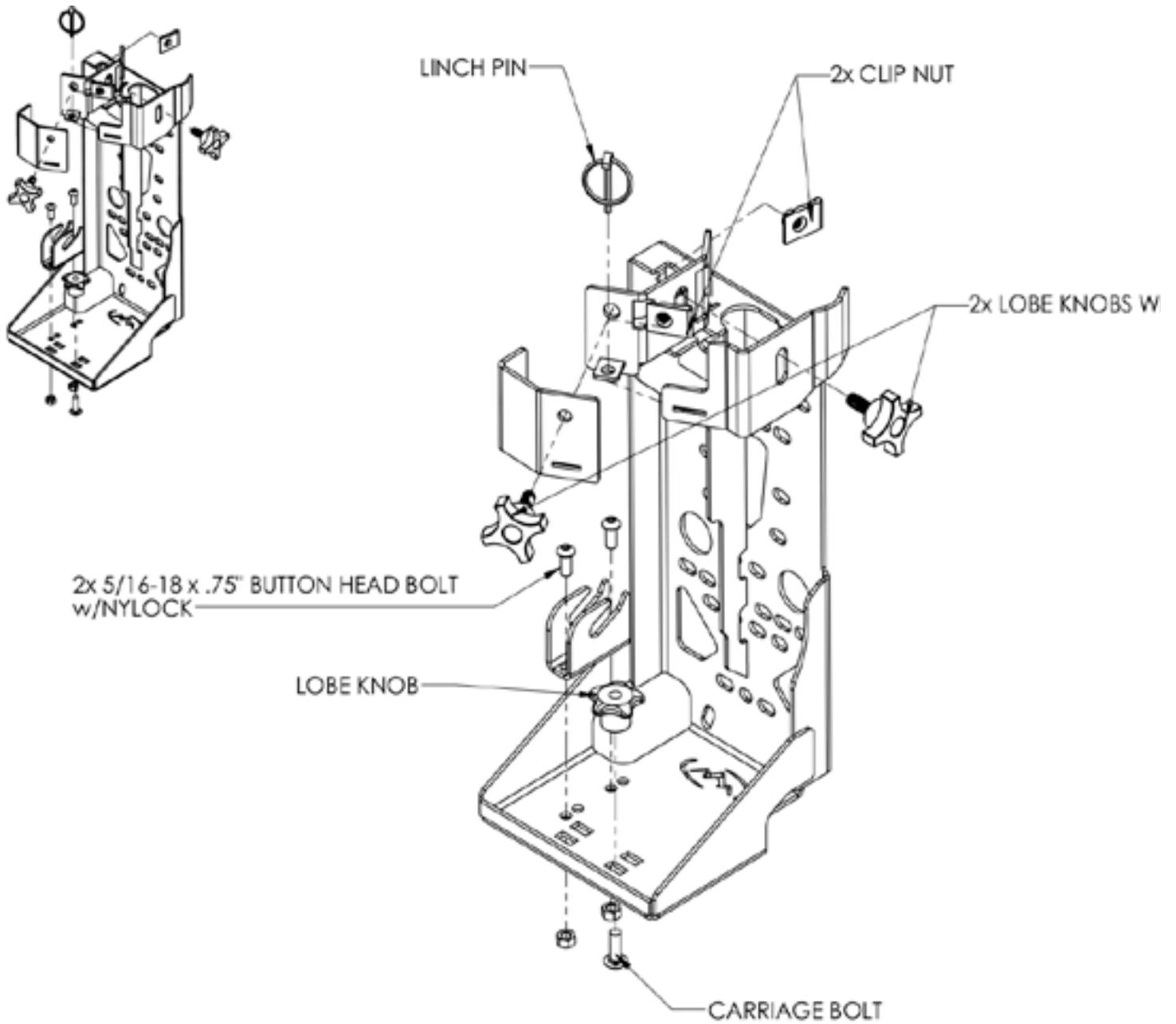

2 HI LIFT PULL PAL MOUNTING

Mount using the 3/8" hardware shown below to the location desired.

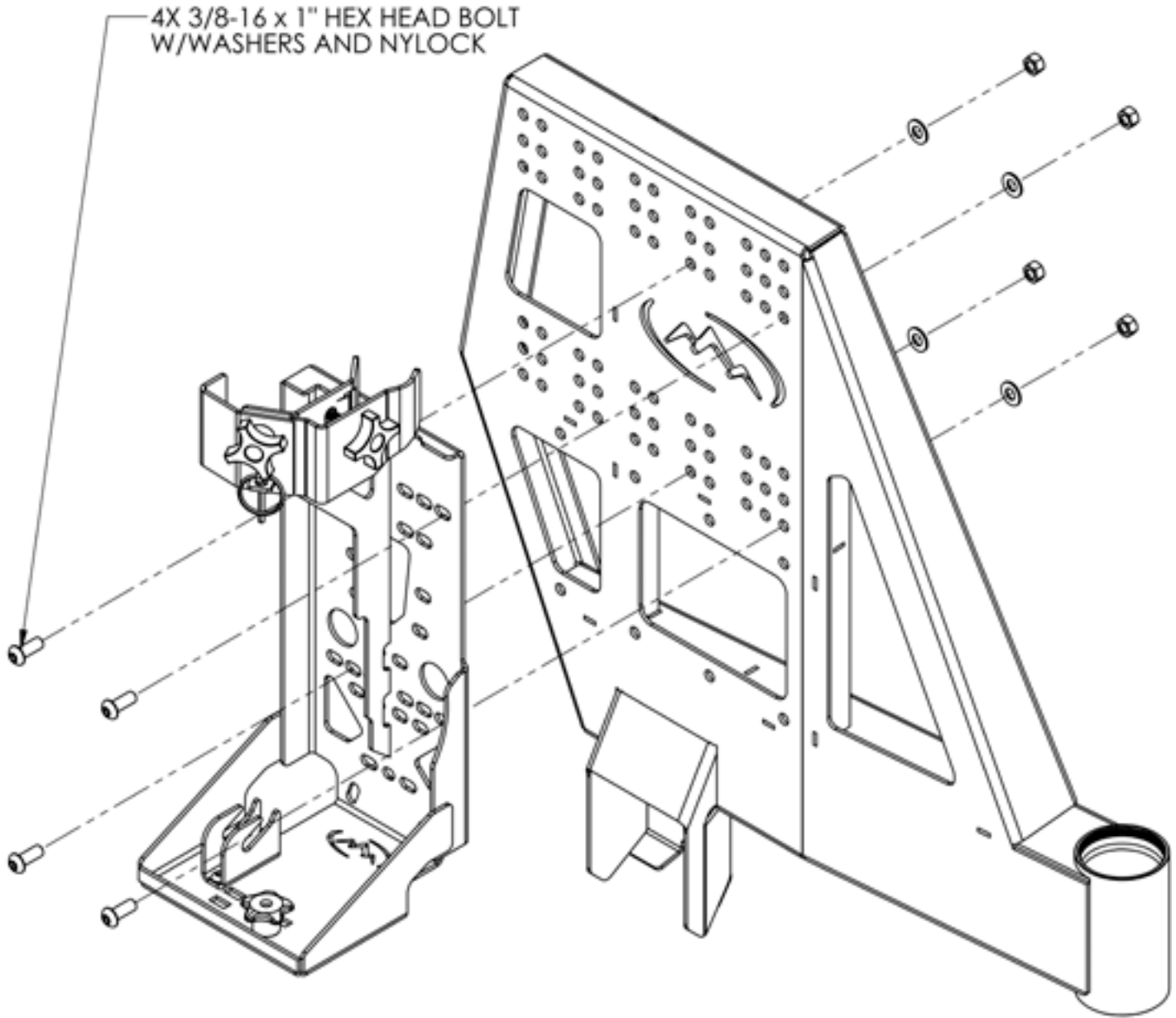

NOTE

Hi Lift Pull Pal mount position is dependent on providing clearance for any hardware, accessories or OEM vehicle features such as lights. Test fit or check for any interference before mounting.